



# PhilGEPS

Philippine Government Electronic Procurement System

Central Portal for  
Philippine Government  
Procurement Opportunities

[Help](#)

## Bid Notice Abstract

### Request for Quotation (RFQ)

**Reference Number** 12923892  
**Procuring Entity** CARLOS HILADO MEMORIAL STATE UNIVERSITY  
**Title** Procurement of Labor and Materials for the Enhancement of Faculty Room (with Faculty Lounge and Enhancement of Restroom) - Binalbagan Campus  
**Area of Delivery** Negros Occidental

<b>Solicitation Number:</b>	RFQ 26-109	<b>Status</b>	<b>Pending</b>
<b>Trade Agreement:</b>	Implementing Rules and Regulations	<b>Associated Components</b>	4
<b>Procurement Mode:</b>	Negotiated Procurement - Small Value Procurement (Sec. 53.9)	<b>Bid Supplements</b>	0
<b>Classification:</b>	Civil Works	<b>Document Request List</b>	0
<b>Category:</b>	Construction Projects	<b>Date Published</b>	18/04/2026
<b>Approved Budget for the Contract:</b>	PHP 900,000.00	<b>Last Updated / Time</b>	17/04/2026 13:02 PM
<b>Delivery Period:</b>	90 Day/s	<b>Closing Date / Time</b>	24/04/2026 09:00 AM
<b>Client Agency:</b>			
<b>Contact Person:</b>	Rowena De la Vida Prado Administrative Assistant II Mabini Street Talisay City Negros Occidental Philippines 6115 63-34-7120005 Ext.142 63-939-9296624 bac.sec@chmsu.edu.ph		

#### Description

Republic of the Philippines  
 CARLOS HILADO MEMORIAL STATE UNIVERSITY  
 Talisay City, Negros Occidental  
 Mobile Phone Number: (0920) 583 3046  
 bac.sec@chmsu.edu.ph

REQUEST FOR QUOTATION  
 Page 1 of 11  
 Date: APRIL 7, 2026  
 Quotation No. 26-109

Please quote your lowest price on the item/s listed below, stating the shortest time of delivery and submit your quotation duly signed by your representative not later than \_\_\_\_\_ in the return envelope attached herewith.

DR. MA. RIZA T. MANALO  
 BAC Chairperson

#### NOTE:

- ALL ENTRIES MAY BE TYPEWRITTEN OR LEGIBLY HANDWRITTEN
- DELIVERY PERIOD WITHIN 90 CALENDAR DAYS
- WARRANTY SHALL BE FOR A PERIOD OF SIX (6) MONTHS FOR SUPPLIES & MATERIALS, ONE (1) YEAR FOR EQUIPMENT, FROM DATE OF ACCEPTANCE BY THE PROCURING ENTITY

4. PRICE VALIDITY SHALL BE FOR A PERIOD OF \_\_\_\_\_ CALENDAR DAYS
5. G-EPS REGISTRATION CERTIFICATE SHALL BE ATTACHED UPON SUBMISSION OF THE QUOTATION
6. BIDDERS SHALL SUBMIT ORIGINAL BROCHURES SHOWING CERTIFICATIONS OF THE PRODUCT BEING OFFERED

ITEM DESCRIPTION OF WORKS QTY. UNIT MATERIAL COST LABOR COST TOTAL COST  
 NO. Unit Cost Material Sub-Total Cost Unit Cost Labor Sub-Total Cost  
 LABOR AND MATERIALS FOR THE ENHANCEMENT OF FACULTY ROOM (WITH FACULTY LOUNGE AND ENHANCEMENT OF RESTROOM) AT BINALBAGAN CAMPUS

#### SCOPE OF WORKS

##### 1.0 GENERAL REQUIREMENTS

- 1.1 Mobilization and Demobilization
- 1.2 Safety Occupational hazards
- 1.3 Site Clearing , Hauling and Grubbing
- 1.4 Scaffolding & Formworks
- 1.5 Demolition of existing walls,tiles,ceiling and existing pantry.
- 1.6 Chipping of walls for electrical and plumbing provision

##### 2.0 CONCRETE AND MASONRY WORKS

- 2.1 CHB wall installation and plastering (See Plan Details)
- 2.2 Pantry Counter

##### 3.0 ARCHITECTURAL WORKS

- 3.1. Carpentry Works
- 3.2. Windows
- 3.3. Doors
- 3.4. Ceiling Works - including covering of holes from existing lighting fixtures
- 3.5 Dry Wall Partitlon
- 3.6 Tile Works - Including covering of holes from existing lighting fixtures
- 3.7 Painting Works (Ceiling, Cabinets, & Chipping Works)

##### 4.0 ELECTRICAL WORKS

##### 5.0 PLUMBING WORKS

##### 6.0 MISCELLANEOUS WORKS

6.1 FOR ALL OTHER ITEMS that are not included on listed Bill of Quantities in your Bid but tare deemed necessary for the completion of the works and the delivery of the project.

#### BILL OF QUANTITIES

##### 1.0 GENERAL REQUIREMENTS

- 1.1 Mobilization and Demobilization 1.00 Lot
  - 1.2 Safety Occupational hazards 1.00 Lot
  - 1.3 Site Clearing , Hauling and Grubbing 1.00 Lot
  - 1.4 Scaffolding & Formworks 1.00 Lot
  - 1.5 Demolition of existing walls,tiles,ceiling and existing pantry. 1.00 Lot
  - 1.6 Chipping of walls for electrical and plumbing provision 1.00 Lot
- Sub-total, 1.0(GENERAL REQUIREMENTS)

##### 2.0 CONCRETE AND MASONRY WORKS

- 2.1 CHB wall installation and plastering (See Plan Details) 39.89 sq.m.
    - 2.1.1 40 kg Cement 68.00 bags
    - 2.1.2 Mixing Sand 2.00 cu.m
    - 2.1.3 Fine Sand 2.00 cu.m
    - 2.1.4 4" Concrete hollow blocks 499.00 pcs
    - 2.1.5 10mmØ x 6m deformed bars 27.00 lgths
    - 2.1.6 #16 G.I. Tie wires 4.00 kgs
    - 2.1.7 4"Ø steel cutting disc 1.00 pcs
  - 2.2 Pantry Counter 0.48 cu.m.
    - 2.2.1 40 kg Cement 4.00 bags
    - 2.2.2 Mixing Sand 0.02 cu.m
    - 2.2.3 3/4" Gravel 0.48 cu.m
    - 2.2.4 10mmØ x 6m deformed bars 7.00 lgths
- Sub-total, 2.0 (CONCRETE AND MASONRY WORKS)

##### 3.0 ARCHITECTURAL WORKS

- 3.1 Carpentry Works
  - 3.1.1 3/4" thk Marine Plywood 8.00 Pcs
  - 3.1.2 Wood Glue 3.00 ltrs
  - 3.1.3 Assorted nails 5.00 kgs
  - 3.1.4 Fluted Pvc Wall Panels 160x24x2950mm 32.00 pcs
  - 3.1.5 Cabinet Accessories 1.00 lot

Sub-total, 3.1 (Carpentry Works)
- 3.2 Windows
  - 3.2.1 2.4m x 1.2m Sliding window w/, 1/4" thk glass w/ Aluminum Frame 2.88 sq.m.
  - 3.2.2 0.6m x 0.6m Awning window, 1/4" thk glass w/ Aluminum Frame 0.72 sq.m.
  - 3.2.3 1m x 0.8m Vanity Mirror 0.80 sq.m.
  - 3.2.4 0.6m x 0.5m Vanity Mirror 0.30 sq.m.

Sub-total, 3.2 (Windows)

##### 3.3 Doors

- 3.3.1 2.1 x 1m Solid Panel Door w/ 2x6" Door Jamb and accessories 1.00 set
  - 3.3.2 2.10m x 1.4m Sliding 1/4" thk glass door w/ aluminum frame and accessories 2.94 sq.m.
  - 3.3.3 2.6m x 3.2m Sliding 1/4" thk glass door w/ aluminum frame and accessories 8.32 sq.m.
  - 3.3.4 0.6m x 2.1m PVC door w/ door jamb and accessories 2.00 sets
- 3.4 Ceiling Works - including covering of holes from existing lighting fixtures 39.48 sq.m.

3.4.1 Fiber Cement Board 3.5mm Thk. 14.00 Pcs  
 3.4.2 Assorted Nails Size #1 #2 #3 #4 10.00 Kg  
 3.4.3 Double Furring 1"X2"X16' 0.5mm 36.00 Pcs  
 3.4.4 Carrying Channel 1"X2"X16', 0.8mm 10.00 Pcs  
 3.4.5 Wall angle 16.00 Pcs  
 3.4.6 Diamond Cutting Disc 4" 1.00 pcs  
 3.4.7 Metal Cutting Disc 4" 1.00 pcs  
 3.4.8 Blind Rivets 3/16" X1/2" 2.00 Box  
 Sub-total, 3.4 (Ceiling Works)

3.5 Dry Wall Partition 75.17 sq.m.  
 3.5.1 Fiber Cement Board 4.5mm Thk. 26.00 pcs  
 3.5.2 Assorted Nails Size #1 #2 #3 #4 10.00 Kg  
 3.5.3 Metal Stud 2"x3" 75.00 pcs  
 3.5.4 Diamond Cutting Disc 4" 1.00 pc  
 3.5.5 Blind Rivets 1/8" X1/2" 4.00 Box  
 3.5.6 Metal Cutting Disc 4" 3.00 pcs  
 Sub-total, 3.5 (Dry Wall Partition)

3.6 Tile Works (1" Thk copping) 144.57 m<sup>2</sup>  
 3.6.1 Glazed Tiles 60x60cm (See Plan Details) 363.00 pcs  
 3.6.2 Glazed Tiles 30x60cm (See Plan Details) 86.00 pcs  
 3.6.3 Unglazed Tiles 30x30cm (See Plan Details) 66.00 pcs  
 3.6.4 Tile Grout 15.00 bags  
 3.6.5 Cement 44.00 Bags  
 3.6.6 Fine sand 4.00 cu.m  
 3.6.7 3" Concrete Toppling (1:4 mix ratio/Dry pack) 10.84 m<sup>3</sup>  
 3.6.8 Cement 84.00 Bags  
 3.6.9 River Sand 9.81 cu.m  
 Sub-total, 3.6 (Tile Works)

3.7 Painting Works (Ceiling, Cabinets, & Chipping Works)  
 3.7.1 Surface Preparation, Primer, & Double Top Coating (Interior & Exterior Walls, Columns, Ceiling) 345.57 Sq.m  
 Sub-total, 3.7 (Painting Works)

#### 4.0 ELECTRICAL WORKS

4.1 Distribution Panel Board, Surface Mounted With Circuit Breakers (12-Branches), 100A Main Breaker, 3-15A(new), 2-20A(existing), 5-30A(existing) 1.00 lot  
 4.2 2" PVC Pipe (Electrical) 1.00 lgth  
 4.3 3.5mm<sup>2</sup> THHN Wire 2.00 Roll  
 4.4 5.5mm<sup>2</sup> THHN Wire 2.00 Roll  
 4.5 PVC Electrical Pipe 1/2" 5.00 Pcs  
 4.6 Utility Box 39.00 Pcs  
 4.7 Junction Box With Cover 22.00 Pcs  
 4.8 One-Gang Switch 2.00 Unit  
 4.9 Two-Gang Switch 4.00 Unit  
 4.10 Duplex Convenience Outlet 22.00 pcs  
 4.11 LED Bulb 12W 39.00 set  
 4.12 LED Automatic Emergency Light 5.00 Unit  
 4.13 LED Linear Strip Lights w/ aluminum frame 45.00 l.m.  
 4.14 Exhaust Fan 8" 2.00 pcs  
 Sub-total, 4.0 (Electrical Works)

#### 5.0 PLUMBING WORKS

5.1 Toilet Fixtures w/ Lavatory and accessories 1.00 set  
 5.2 Toilet Fixtures 1.00 set  
 5.3 Urinal 1.00 set  
 5.4 Single Bowl SS Kitchen Sink 1.00 unit  
 5.5 Counter Top Sink 1.00 unit  
 5.6 Goose Neck Faucet 2.00 pc  
 5.7 Toilet Bidet 2.00 pc  
 5.8 4"PVC Pipe (Sanitary) S600 4.00 pcs  
 5.9 4" 45 deg.PVC Elbow (Sanitary) 4.00 pcs  
 5.10 4"x 4" PVC WYE (Sanitary) 4.00 pcs  
 5.11 4" x 2" PVC WYE (Sanitary) 5.00 pcs  
 5.12 2" x 2" PVC WYE (Sanitary) 1.00 pcs  
 5.13 2" Ptrap 6.00 pcs  
 5.14 2".PVC Pipe (Sanitary) 7.00 pcs  
 5.15 2" 90 deg.PVC Elbow (Sanitary) 10.00 pcs  
 5.16 4" pvc Clean out 3.00 pcs  
 5.17 3/4" dia, Pvc pipe (Water line) 5.00 lgths  
 5.18 3/4" 45 deg. PVC Elbow (Water line) 9.00 pcs  
 5.19 4" x 4" Stainless Floor Drain 2.00 pc  
 5.20 PVC Solvent 400 CC 2.00 cans  
 5.21 06.m x 32mm Stainless Steel Toilet grab bar 2.00 pcs  
 5.22 Stainless Steel Grease Trap - 7gpm 2.00 sets  
 Sub-total, 5.0 (Plumbing Works)

#### 6.0 MISCELLANEOUS WORKS

6.1 FOR ALL OTHER ITEMS that are not included on listed Bill of Quantities in your Bid but are deemed necessary for the completion of the works and the delivery of the project. 1.00 lot  
 Sub-total, 6.0 (MISCELLANEOUS WORKS)

PROJECT DURATION: 90 CALENDAR DAYS

Note: Attach Certificate of Site Inspection

A. TOTAL DIRECT COST

B. CONSUMABLES:

C. SUPERVISION AND ADMINISTRATION:

D. TOTAL INDIRECT COST (B+C):

E. TOTAL COST (A+D)

F. VAT (12% OF ITEM E):

GRAND TOTAL OF PROJECT COST:

\*\*\*\*\*NOTHING FOLLOWS\*\*\*\*\*

TOTAL ABC = Php 900,000.00

PROCUREMENT OF LABOR AND MATERIALS FOR THE ENHANCEMENT OF FACULTY ROOM (WITH FACULTY LOUNGE AND ENHANCEMENT OF RESTROOM) - BINALBAGAN CAMPUS/ A.M.A. PANCHO (GAD Director)

PR# 26-211-0324 03-24-26

MDS 102-101-26-03 03-24-26

**Line Items**

Item No.	Product/Service Name	Description	Quantity	UOM	Budget (PHP)
1	One (1) Lot	Procurement of Labor and Materials for the Enhancement of Faculty Room (with Faculty Lounge and Enhancement of Restroom) - Binalbagan Campus	1	Lot	900,000.00

**Created by** Rowena De la Vida Prado

**Date Created** 17/04/2026

The PhilGEPS team is not responsible for any typographical errors or misinformation presented in the system. PhilGEPS only displays information provided for by its clients, and any queries regarding the postings should be directed to the contact person/s of the concerned party.



Republic of the Philippines  
**CARLOS HILADO MEMORIAL STATE UNIVERSITY**  
 Talisay City, Negros Occidental  
 Mobile Phone Number: (0920) 583 3046  
[bac.sec@chmsu.edu.ph](mailto:bac.sec@chmsu.edu.ph)

## REQUEST FOR QUOTATION

Page 1 of 11

Date: APRIL 7, 2026  
 Quotation No. 26-109

Please quote your lowest price on the item/s listed below, stating the shortest time of delivery and submit your quotation duly signed by your representative not later than \_\_\_\_\_ in the return envelope attached herewith.

  
 DR. MA. RIZA T. MANALO  
 BAC Chairperson

**NOTE:**

- ALL ENTRIES MAY BE TYPEWRITTEN OR LEGIBLY HANDWRITTEN
- DELIVERY PERIOD WITHIN 90 CALENDAR DAYS
- WARRANTY SHALL BE FOR A PERIOD OF SIX (6) MONTHS FOR SUPPLIES & MATERIALS, ONE (1) YEAR FOR EQUIPMENT, FROM DATE OF ACCEPTANCE BY THE PROCURING ENTITY
- PRICE VALIDITY SHALL BE FOR A PERIOD OF \_\_\_\_\_ CALENDAR DAYS
- G-EPS REGISTRATION CERTIFICATE SHALL BE ATTACHED UPON SUBMISSION OF THE QUOTATION
- BIDDERS SHALL SUBMIT ORIGINAL BROCHURES SHOWING CERTIFICATIONS OF THE PRODUCT BEING OFFERED

ITEM NO.	DESCRIPTION OF WORKS	QTY.	UNIT	MATERIAL COST		LABOR COST		TOTAL COST
				Unit Cost	Material Sub-Total Cost	Unit Cost	Labor Sub-Total Cost	
	<b>LABOR AND MATERIALS FOR THE ENHANCEMENT OF FACULTY ROOM (WITH FACULTY LOUNGE AND ENHANCEMENT OF RESTROOM) AT BINALBAGAN CAMPUS</b>							
	<b>SCOPE OF WORKS</b>							
1.0	<b>GENERAL REQUIREMENTS</b>							
1.1	Mobilization and Demobilization							
1.2	Safety Occupational hazards							
1.3	Site Clearing , Hauling and Grubbing							
1.4	Scaffolding & Formworks							
1.5	Demolition of existing walls,tiles,ceiling and existing pantry.							
1.6	Chipping of walls for electrical and plumbing provision							
2.0	<b>CONCRETE AND MASONRY WORKS</b>							
2.1	CHB wall installation and plastering (See Plan Details)							
2.2	Pantry Counter							

Released (BAC) \_\_\_\_\_ Date \_\_\_\_\_ By \_\_\_\_\_  
 Returned (Supplier) \_\_\_\_\_

\_\_\_\_\_  
 Printed Name/Signature

\_\_\_\_\_  
 Tel. No./Cellphone No.

\_\_\_\_\_  
 Date



Republic of the Philippines  
**CARLOS HILADO MEMORIAL STATE UNIVERSITY**  
 Talisay City, Negros Occidental  
 Mobile Phone Number: (0920) 583 3046  
[bac.sec@chmsu.edu.ph](mailto:bac.sec@chmsu.edu.ph)

## REQUEST FOR QUOTATION

Page 2 of 11

Date: APRIL 7, 2026  
 Quotation No. 26-109

Please quote your lowest price on the item/s listed below, stating the shortest time of delivery and submit your quotation duly signed by your representative not later than \_\_\_\_\_ in the return envelope attached herewith.

  
**DR. MA. RIZA T. MANALO**  
 BAC Chairperson

**NOTE:**

1. ALL ENTRIES MAY BE TYPEWRITTEN OR LEGIBLY HANDWRITTEN
2. DELIVERY PERIOD WITHIN 90 CALENDAR DAYS
3. WARRANTY SHALL BE FOR A PERIOD OF SIX (6) MONTHS FOR SUPPLIES & MATERIALS, ONE (1) YEAR FOR EQUIPMENT, FROM DATE OF ACCEPTANCE BY THE PROCURING ENTITY
4. PRICE VALIDITY SHALL BE FOR A PERIOD OF \_\_\_\_\_ CALENDAR DAYS
5. G-EPS REGISTRATION CERTIFICATE SHALL BE ATTACHED UPON SUBMISSION OF THE QUOTATION
6. BIDDERS SHALL SUBMIT ORIGINAL BROCHURES SHOWING CERTIFICATIONS OF THE PRODUCT BEING OFFERED

ITEM NO.	DESCRIPTION OF WORKS	QTY.	UNIT	MATERIAL COST		LABOR COST		TOTAL COST
				Unit Cost	Material Sub-Total Cost	Unit Cost	Labor Sub-Total Cost	
<b>3.0</b>	<b>ARCHITECTURAL WORKS</b>							
3.1.	Carpentry Works							
3.2.	Windows							
3.3.	Doors							
3.4.	Ceiling Works - including covering of holes from existing lighting fixtures							
3.5.	Dry Wall Partition							
3.6.	Tile Works - including covering of holes from existing lighting fixtures							
3.7.	Painting Works (Ceiling, Cabinets, & Chipping Works)							
<b>4.0</b>	<b>ELECTRICAL WORKS</b>							
<b>5.0</b>	<b>PLUMBING WORKS</b>							
<b>6.0</b>	<b>MISCELLANEOUS WORKS</b>							
6.1	<b>FOR ALL OTHER ITEMS</b> that are not included on listed Bill of Quantities in your Bid but are deemed necessary for the completion of the works and the delivery of the project.							

Date \_\_\_\_\_ By \_\_\_\_\_

Released (BAC) \_\_\_\_\_  
 Returned (Supplier) \_\_\_\_\_

Printed Name/Signature

Tel. No./Cellphone No.

Date



Republic of the Philippines  
**CARLOS HILADO MEMORIAL STATE UNIVERSITY**  
 Talisay City, Negros Occidental  
 Mobile Phone Number: (0920) 583 3046  
[bac.sec@chmsu.edu.ph](mailto:bac.sec@chmsu.edu.ph)

## REQUEST FOR QUOTATION

Page 3 of 11

Date: APRIL 7, 2026  
 Quotation No. 26-109

Please quote your lowest price on the item/s listed below, stating the shortest time of delivery and submit your quotation duly signed by your representative not later than \_\_\_\_\_ in the return envelope attached herewith.

  
 DR. MA. RIZA T. MANALO  
 BAC Chairperson

### NOTE:

1. ALL ENTRIES MAY BE TYPEWRITTEN OR LEGIBLY HANDWRITTEN
2. DELIVERY PERIOD WITHIN 90 CALENDAR DAYS
3. WARRANTY SHALL BE FOR A PERIOD OF SIX (6) MONTHS FOR SUPPLIES & MATERIALS, ONE (1) YEAR FOR EQUIPMENT, FROM DATE OF ACCEPTANCE BY THE PROCURING ENTITY
4. PRICE VALIDITY SHALL BE FOR A PERIOD OF \_\_\_\_\_ CALENDAR DAYS
5. G-EPS REGISTRATION CERTIFICATE SHALL BE ATTACHED UPON SUBMISSION OF THE QUOTATION
6. BIDDERS SHALL SUBMIT ORIGINAL BROCHURES SHOWING CERTIFICATIONS OF THE PRODUCT BEING OFFERED

ITEM NO.	DESCRIPTION OF WORKS	QTY.	UNIT	MATERIAL COST		LABOR COST		TOTAL COST
				Unit Cost	Material Sub-Total Cost	Unit Cost	Labor Sub-Total Cost	
	<b>BILL OF QUANTITIES</b>							
<b>1.0</b>	<b>GENERAL REQUIREMENTS</b>							
1.1	Mobilization and Demobilization	1.00	Lot					
1.2	Safety Occupational hazards	1.00	Lot					
1.3	Site Clearing , Hauling and Grubbing	1.00	Lot					
1.4	Scaffolding & Formworks	1.00	Lot					
1.5	Demolition of existing walls,tiles,ceiling and existing pantry.	1.00	Lot					
1.6	Chipping of walls for electrical and plumbing provision	1.00	Lot					
	<b>Sub-total, 1.0(GENERAL REQUIREMENTS)</b>							
<b>2.0</b>	<b>CONCRETE AND MASONRY WORKS</b>							
<b>2.1</b>	<b>CHB wall installation and plastering (See Plan Details)</b>	39.89	sq.m.					
2.1.1	40 kg Cement	68.00	bags					
2.1.2	Mixing Sand	2.00	cu.m					
2.1.3	Fine Sand	2.00	cu.m					

Released (BAC) \_\_\_\_\_ Date \_\_\_\_\_ By \_\_\_\_\_  
 Returned (Supplier) \_\_\_\_\_

\_\_\_\_\_  
 Printed Name/Signature  
 \_\_\_\_\_  
 Tel. No./Cellphone No.  
 \_\_\_\_\_  
 \_\_\_\_\_  
 Date



Republic of the Philippines  
**CARLOS HILADO MEMORIAL STATE UNIVERSITY**  
Talisay City, Negros Occidental  
Mobile Phone Number: (0920) 583 3046  
[bac.sec@chmsu.edu.ph](mailto:bac.sec@chmsu.edu.ph)

## REQUEST FOR QUOTATION

Page 4 of 11

Date: APRIL 7, 2026  
Quotation No. 26-109

Please quote your lowest price on the item/s listed below, stating the shortest time of delivery and submit your quotation duly signed by your representative not later than \_\_\_\_\_ in the return envelope attached herewith.

  
DR. MA. RIZA T. MANALO  
BAC Chairperson

### NOTE:

1. ALL ENTRIES MAY BE TYPEWRITTEN OR LEGIBLY HANDWRITTEN
2. DELIVERY PERIOD WITHIN 90 CALENDAR DAYS
3. WARRANTY SHALL BE FOR A PERIOD OF SIX (6) MONTHS FOR SUPPLIES & MATERIALS, ONE (1) YEAR FOR EQUIPMENT, FROM DATE OF OF ACCEPTANCE BY THE PROCURING ENTITY
4. PRICE VALIDITY SHALL BE FOR A PERIOD OF \_\_\_\_\_ CALENDAR DAYS
5. G-EPS REGISTRATION CERTIFICATE SHALL BE ATTACHED UPON SUBMISSION OF THE QUOTATION
6. BIDDERS SHALL SUBMIT ORIGINAL BROCHURES SHOWING CERTIFICATIONS OF THE PRODUCT BEING OFFERED

ITEM NO.	DESCRIPTION OF WORKS	QTY.	UNIT	MATERIAL COST		LABOR COST		TOTAL COST
				Unit Cost	Material Sub-Total Cost	Unit Cost	Labor Sub-Total Cost	
2.1.4	4" Concrete hollow blocks	499.00	pcs					
2.1.5	10mmØ x 6m deformed bars	27.00	lgths					
2.1.6	#16 G.I. Tie wires	4.00	kgs					
2.1.7	4"Ø steel cutting disc	1.00	pcs					
<b>2.2</b>	<b>Pantry Counter</b>	0.48	cu.m.					
2.2.1	40 kg Cement	4.00	bags					
2.2.2	Mixing Sand	0.02	cu.m					
2.2.3	3/4" Gravel	0.48	cu.m					
2.2.4	10mmØ x 6m deformed bars	7.00	lgths					
	<b>Sub-total, 2.0 (CONCRETE AND MASONRY WORKS)</b>							
<b>3.0</b>	<b>ARCHITECTURAL WORKS</b>							
<b>3.1</b>	<b>Carpentry Works</b>							
3.1.1	3/4" thk Marine Plywood	8.00	Pcs					
3.1.2	Wood Glue	3.00	ltrs					
3.1.3	Assorted nails	5.00	kgs					
3.1.4	Fluted Pvc Wall Panels 160x24x2950mm	32.00	pcs					
3.1.5	Cabinet Accessories	1.00	lot					
	<b>Sub-total, 3.1 (Carpentry Works)</b>							

Date \_\_\_\_\_ By \_\_\_\_\_

Released (BAC) \_\_\_\_\_  
Returned (Supplier) \_\_\_\_\_

Printed Name/Signature

Tel. No./Cellphone No.

Date



Republic of the Philippines  
**CARLOS HILADO MEMORIAL STATE UNIVERSITY**  
Talisay City, Negros Occidental  
Mobile Phone Number: (0920) 583 3046  
[bac.sec@chmsu.edu.ph](mailto:bac.sec@chmsu.edu.ph)

## REQUEST FOR QUOTATION

Page 5 of 11

Date: APRIL 7, 2026  
Quotation No. 26-109

Please quote your lowest price on the item/s listed below, stating the shortest time of delivery and submit your quotation duly signed by your representative not later than \_\_\_\_\_ in the return envelope attached herewith.

  
DR. MA. RIZA T. MANALO  
BAC Chairperson

### NOTE:

1. ALL ENTRIES MAY BE TYPEWRITTEN OR LEGIBLY HANDWRITTEN
2. DELIVERY PERIOD WITHIN 90 CALENDAR DAYS
3. WARRANTY SHALL BE FOR A PERIOD OF SIX (6) MONTHS FOR SUPPLIES & MATERIALS, ONE (1) YEAR FOR EQUIPMENT, FROM DATE OF ACCEPTANCE BY THE PROCURING ENTITY
4. PRICE VALIDITY SHALL BE FOR A PERIOD OF \_\_\_\_\_ CALENDAR DAYS
5. G-EPS REGISTRATION CERTIFICATE SHALL BE ATTACHED UPON SUBMISSION OF THE QUOTATION
6. BIDDERS SHALL SUBMIT ORIGINAL BROCHURES SHOWING CERTIFICATIONS OF THE PRODUCT BEING OFFERED

ITEM NO.	DESCRIPTION OF WORKS	QTY.	UNIT	MATERIAL COST		LABOR COST		TOTAL COST
				Unit Cost	Material Sub-Total Cost	Unit Cost	Labor Sub-Total Cost	
<b>3.2</b>	<b>Windows</b>							
3.2.1	2.4m x 1.2m Sliding window w/, 1/4" thk glass w/ Aluminum Frame	2.88	sq.m.					
3.2.2	0.6m x 0.6m Awning window, 1/4" thk glass w/ Aluminum Frame	0.72	sq.m.					
3.2.3	1m x 0.8m Vanity Mirror	0.80	sq.m.					
3.2.4	0.6m x 0.5m Vanity Mirror	0.30	sq.m.					
	<b>Sub-total, 3.2 (Windows)</b>							
<b>3.3</b>	<b>Doors</b>							
3.3.1	2.1 x 1m Solid Panel Door w/ 2x6" Door Jamb and accessories	1.00	set					
3.3.2	2.10m x 1.4m Sliding 1/4" thk glass door w/ aluminum frame and accessories	2.94	sq.m.					
3.3.3	2.6m x 3.2m Sliding 1/4" thk glass door w/ aluminum frame and accessories	8.32	sq.m.					
3.3.4	0.6m x 2.1m PVC door w/ door jamb and accessories	2.00	sets					

Date \_\_\_\_\_ By \_\_\_\_\_

Released (BAC) \_\_\_\_\_  
Returned (Supplier) \_\_\_\_\_

Printed Name/Signature

Tel. No./Cellphone No.

Date



Republic of the Philippines  
**CARLOS HILADO MEMORIAL STATE UNIVERSITY**  
Talisay City, Negros Occidental  
Mobile Phone Number: (0920) 583 3046  
[bac.sec@chmsu.edu.ph](mailto:bac.sec@chmsu.edu.ph)

## REQUEST FOR QUOTATION

Page 6 of 11

Date: APRIL 7, 2026  
Quotation No. 26-109

Please quote your lowest price on the item/s listed below, stating the shortest time of delivery and submit your quotation duly signed by your representative not later than \_\_\_\_\_ in the return envelope attached herewith.

  
DR. MA. RIZA T. MANALO  
BAC Chairperson

### NOTE:

1. ALL ENTRIES MAY BE TYPEWRITTEN OR LEGIBLY HANDWRITTEN
2. DELIVERY PERIOD WITHIN 90 CALENDAR DAYS
3. WARRANTY SHALL BE FOR A PERIOD OF SIX (6) MONTHS FOR SUPPLIES & MATERIALS, ONE (1) YEAR FOR EQUIPMENT, FROM DATE OF ACCEPTANCE BY THE PROCURING ENTITY
4. PRICE VALIDITY SHALL BE FOR A PERIOD OF \_\_\_\_\_ CALENDAR DAYS
5. G-EPS REGISTRATION CERTIFICATE SHALL BE ATTACHED UPON SUBMISSION OF THE QUOTATION
6. BIDDERS SHALL SUBMIT ORIGINAL BROCHURES SHOWING CERTIFICATIONS OF THE PRODUCT BEING OFFERED

ITEM NO.	DESCRIPTION OF WORKS	QTY.	UNIT	MATERIAL COST		LABOR COST		TOTAL COST
				Unit Cost	Material Sub-Total Cost	Unit Cost	Labor Sub-Total Cost	
3.4	<b>Ceiling Works - including covering of holes from existing lighting fixtures</b>	39.48	sq.m.					
3.4.1	Fiber Cement Board 3.5mm Thk.	14.00	Pcs					
3.4.2	Assorted Nails Size #1 #2 #3 #4	10.00	Kg					
3.4.3	Double Furring 1"X2"X16' 0.5mm	36.00	Pcs					
3.4.4	Carrying Channel 1"X2"X16', 0.8mm	10.00	Pcs					
3.4.5	Wall angle	16.00	Pcs					
3.4.6	Diamond Cutting Disc 4"	1.00	pcs					
3.4.7	Metal Cutting Disc 4"	1.00	pcs					
3.4.8	Blind Rivets 3/16" X1/2"	2.00	Box					
	<b>Sub-total, 3.4 (Ceiling Works)</b>							
3.5	<b>Dry Wall Partition</b>	75.17	sq.m.					
3.5.1	Fiber Cement Board 4.5mm Thk.	26.00	pcs					
3.5.2	Assorted Nails Size #1 #2 #3 #4	10.00	Kg					
3.5.3	Metal Stud 2"x3"	75.00	pcs					

Date \_\_\_\_\_ By \_\_\_\_\_

Released (BAC) \_\_\_\_\_  
Returned (Supplier) \_\_\_\_\_

Printed Name/Signature

Tel. No./Cellphone No.

Date



Republic of the Philippines  
**CARLOS HILADO MEMORIAL STATE UNIVERSITY**  
 Talisay City, Negros Occidental  
 Mobile Phone Number: (0920) 583 3046  
[bac.sec@chmsu.edu.ph](mailto:bac.sec@chmsu.edu.ph)

## REQUEST FOR QUOTATION

Page 7 of 11

Date: APRIL 7, 2026  
 Quotation No. 26-109

Please quote your lowest price on the item/s listed below, stating the shortest time of delivery and submit your quotation duly signed by your representative not later than \_\_\_\_\_ in the return envelope attached herewith.

  
**DR. MA. RIZA T. MANALO**  
 BAC Chairperson

### NOTE:

1. ALL ENTRIES MAY BE TYPEWRITTEN OR LEGIBLY HANDWRITTEN
2. DELIVERY PERIOD WITHIN 90 CALENDAR DAYS
3. WARRANTY SHALL BE FOR A PERIOD OF SIX (6) MONTHS FOR SUPPLIES & MATERIALS, ONE (1) YEAR FOR EQUIPMENT, FROM DATE OF ACCEPTANCE BY THE PROCURING ENTITY
4. PRICE VALIDITY SHALL BE FOR A PERIOD OF \_\_\_\_\_ CALENDAR DAYS
5. G-EPS REGISTRATION CERTIFICATE SHALL BE ATTACHED UPON SUBMISSION OF THE QUOTATION
6. BIDDERS SHALL SUBMIT ORIGINAL BROCHURES SHOWING CERTIFICATIONS OF THE PRODUCT BEING OFFERED

ITEM NO.	DESCRIPTION OF WORKS	QTY.	UNIT	MATERIAL COST		LABOR COST		TOTAL COST
				Unit Cost	Material Sub-Total Cost	Unit Cost	Labor Sub-Total Cost	
3.5.4	Diamond Cutting Disc 4"	1.00	pc					
3.5.5	Blind Rivets 1/8" X1/2"	4.00	Box					
3.5.6	Metal Cutting Disc 4"	3.00	pcs					
	<b>Sub-total, 3.5 (Dry Wall Partition)</b>							
<b>3.6</b>	<b>Tile Works (1" Thk coping)</b>	144.57	m <sup>2</sup>					
3.6.1	Glazed Tiles 60x60cm (See Plan Details)	363.00	pcs					
3.6.2	Glazed Tiles 30x60cm (See Plan Details)	86.00	pcs					
3.6.3	Unglazed Tiles 30x30cm (See Plan Details)	66.00	pcs					
3.6.4	Tile Grout	15.00	bags					
3.6.5	Cement	44.00	Bags					
3.6.6	Fine sand	4.00	cu.m					
3.6.7	3" Concrete Topping (1:4 mix ratio/Dry pack)	10.84	m <sup>3</sup>					
3.6.8	Cement	84.00	Bags					
3.6.9	River Sand	9.81	cu.m					
	<b>Sub-total, 3.6 (Tile Works)</b>							

Date

By

Released (BAC) \_\_\_\_\_

Returned (Supplier) \_\_\_\_\_

Printed Name/Signature

Tel. No./Cellphone No.

Date



Republic of the Philippines  
**CARLOS HILADO MEMORIAL STATE UNIVERSITY**  
 Talisay City, Negros Occidental  
 Mobile Phone Number: (0920) 583 3046  
[bac.sec@chmsu.edu.ph](mailto:bac.sec@chmsu.edu.ph)

## REQUEST FOR QUOTATION

Page 8 of 11

Date: APRIL 7, 2026  
 Quotation No. 26-109

Please quote your lowest price on the item/s listed below, stating the shortest time of delivery and submit your quotation duly signed by your representative not later than \_\_\_\_\_ in the return envelope attached herewith.

  
 DR. MA. RIZA T. MANALO  
 BAC Chairperson

**NOTE:**

1. ALL ENTRIES MAY BE TYPEWRITTEN OR LEGIBLY HANDWRITTEN
2. DELIVERY PERIOD WITHIN 90 CALENDAR DAYS
3. WARRANTY SHALL BE FOR A PERIOD OF SIX (6) MONTHS FOR SUPPLIES & MATERIALS, ONE (1) YEAR FOR EQUIPMENT, FROM DATE OF ACCEPTANCE BY THE PROCURING ENTITY
4. PRICE VALIDITY SHALL BE FOR A PERIOD OF \_\_\_\_\_ CALENDAR DAYS
5. G-EPS REGISTRATION CERTIFICATE SHALL BE ATTACHED UPON SUBMISSION OF THE QUOTATION
6. BIDDERS SHALL SUBMIT ORIGINAL BROCHURES SHOWING CERTIFICATIONS OF THE PRODUCT BEING OFFERED

ITEM NO.	DESCRIPTION OF WORKS	QTY.	UNIT	MATERIAL COST		LABOR COST		TOTAL COST
				Unit Cost	Material Sub-Total Cost	Unit Cost	Labor Sub-Total Cost	
3.7	<b>Painting Works (Ceiling, Cabinets, &amp; Chipping Works)</b>							
3.7.1	Surface Preparation, Primer, & Double Top Coating (Interior & Exterior Walls, Columns, Ceiling)	345.57	Sq.m					
	<b>Sub-total, 3.7 (Painting Works)</b>							
4.0	<b>ELECTRICAL WORKS</b>							
4.1	Distribution Panel Board, Surface Mounted With Circuit Breakers (12-Branched), 100A Main Breaker, 3-15A(new), 2-20A(existing), 5-30A(existing)	1.00	lot					
4.2	2" PVC Pipe (Electrical)	1.00	lgth					
4.3	3.5mm2 THHN Wire	2.00	Roll					
4.4	5.5mm2 THHN Wire	2.00	Roll					
4.5	PVC Electrical Pipe 1/2"	5.00	Pcs					
4.6	Utility Box	39.00	Pcs					
4.7	Junction Box With Cover	22.00	Pcs					

Released (BAC) \_\_\_\_\_ Date \_\_\_\_\_ By \_\_\_\_\_  
 Returned (Supplier) \_\_\_\_\_

\_\_\_\_\_  
 Printed Name/Signature  
 \_\_\_\_\_  
 Tel. No./Cellphone No.  
 \_\_\_\_\_  
 Date



Republic of the Philippines  
**CARLOS HILADO MEMORIAL STATE UNIVERSITY**  
 Talisay City, Negros Occidental  
 Mobile Phone Number: (0920) 583 3046  
[bac.sec@chmsu.edu.ph](mailto:bac.sec@chmsu.edu.ph)

## REQUEST FOR QUOTATION

Page 9 of 11

Date: APRIL 7, 2026  
 Quotation No. 26-109

Please quote your lowest price on the item/s listed below, stating the shortest time of delivery and submit your quotation duly signed by your representative not later than \_\_\_\_\_ in the return envelope attached herewith.

  
 DR. MA. RIZA T. MANALO  
 BAC Chairperson

### NOTE:

1. ALL ENTRIES MAY BE TYPEWRITTEN OR LEGIBLY HANDWRITTEN
2. DELIVERY PERIOD WITHIN 90 CALENDAR DAYS
3. WARRANTY SHALL BE FOR A PERIOD OF SIX (6) MONTHS FOR SUPPLIES & MATERIALS, ONE (1) YEAR FOR EQUIPMENT, FROM DATE OF ACCEPTANCE BY THE PROCURING ENTITY
4. PRICE VALIDITY SHALL BE FOR A PERIOD OF \_\_\_\_\_ CALENDAR DAYS
5. G-EPS REGISTRATION CERTIFICATE SHALL BE ATTACHED UPON SUBMISSION OF THE QUOTATION
6. BIDDERS SHALL SUBMIT ORIGINAL BROCHURES SHOWING CERTIFICATIONS OF THE PRODUCT BEING OFFERED

ITEM NO.	DESCRIPTION OF WORKS	QTY.	UNIT	MATERIAL COST		LABOR COST		TOTAL COST
				Unit Cost	Material Sub-Total Cost	Unit Cost	Labor Sub-Total Cost	
4.8	One-Gang Switch	2.00	Unit					
4.9	Two-Gang Switch	4.00	Unit					
4.10	Duplex Convenience Outlet	22.00	pcs					
4.11	LED Bulb 12W	39.00	set					
4.12	LED Automatic Emergency Light	5.00	Unit					
4.13	LED Linear Strip Lights w/ aluminum frame	45.00	l.m.					
4.14	Exhaust Fan 8"	2.00	pcs					
	<b>Sub-total, 4.0 (Electrical Works)</b>							
<b>5.0</b>	<b>PLUMBING WORKS</b>							
5.1	Toilet Fixtures w/ Lavatory and accessories	1.00	set					
5.2	Toilet Fixtures	1.00	set					
5.3	Urinal	1.00	set					
5.4	Single Bowl SS Kitchen Sink	1.00	unit					
5.5	Counter Top Sink	1.00	unit					
5.6	Goose Neck Faucet	2.00	pc					

Released (BAC) \_\_\_\_\_ Date \_\_\_\_\_ By \_\_\_\_\_  
 Returned (Supplier) \_\_\_\_\_

\_\_\_\_\_  
 Printed Name/Signature

\_\_\_\_\_  
 Tel. No./Cellphone No.

\_\_\_\_\_  
 Date



Republic of the Philippines  
**CARLOS HILADO MEMORIAL STATE UNIVERSITY**  
 Talisay City, Negros Occidental  
 Mobile Phone Number: (0920) 583 3046  
[bac.sec@chmsu.edu.ph](mailto:bac.sec@chmsu.edu.ph)

## REQUEST FOR QUOTATION

Page 10 of 11

Date: APRIL 7, 2026  
 Quotation No. 26-109

Please quote your lowest price on the item/s listed below, stating the shortest time of delivery and submit your quotation duly signed by your representative not later than \_\_\_\_\_ in the return envelope attached herewith.

  
**DR. MA. RIZA T. MANALO**  
 BAC Chairperson

**NOTE:**

1. ALL ENTRIES MAY BE TYPEWRITTEN OR LEGIBLY HANDWRITTEN
2. DELIVERY PERIOD WITHIN 90 CALENDAR DAYS
3. WARRANTY SHALL BE FOR A PERIOD OF SIX (6) MONTHS FOR SUPPLIES & MATERIALS, ONE (1) YEAR FOR EQUIPMENT, FROM DATE OF ACCEPTANCE BY THE PROCURING ENTITY
4. PRICE VALIDITY SHALL BE FOR A PERIOD OF \_\_\_\_\_ CALENDAR DAYS
5. G-EPS REGISTRATION CERTIFICATE SHALL BE ATTACHED UPON SUBMISSION OF THE QUOTATION
6. BIDDERS SHALL SUBMIT ORIGINAL BROCHURES SHOWING CERTIFICATIONS OF THE PRODUCT BEING OFFERED

ITEM NO.	DESCRIPTION OF WORKS	QTY.	UNIT	MATERIAL COST		LABOR COST		TOTAL COST
				Unit Cost	Material Sub-Total Cost	Unit Cost	Labor Sub-Total Cost	
5.7	Toilet Bidet	2.00	pc					
5.8	4"PVC Pipe (Sanitary) S600	4.00	pcs					
5.9	4" 45 deg.PVC Elbow (Sanitary)	4.00	pcs					
5.10	4"x 4" PVC WYE (Sanitary)	4.00	pcs					
5.11	4" x 2" PVC WYE (Sanitary)	5.00	pcs					
5.12	2" x 2" PVC WYE (Sanitary)	1.00	pcs					
5.13	2" Ptrap	6.00	pcs					
5.14	2".PVC Pipe (Sanitary)	7.00	pcs					
5.15	2" 90 deg.PVC Elbow (Sanitary)	10.00	pcs					
5.16	4" pvc Clean out	3.00	pcs					
5.17	3/4" dia, Pvc pipe (Water line)	5.00	lgths					
5.18	3/4" 45 deg. PVC Elbow (Water line)	9.00	pcs					
5.19	4" x 4" Stainless Floor Drain	2.00	pc					
5.20	PVC Solvent 400 CC	2.00	cans					
5.21	06.m x 32mm Stainless Steel Toilet grab bar	2.00	pcs					
5.22	Stainless Steel Grease Trap - 7gpm	2.00	sets					
	<b>Sub-total, 5.0 (Plumbing Works)</b>							

Date \_\_\_\_\_ By \_\_\_\_\_

Released (BAC) \_\_\_\_\_  
 Returned (Supplier) \_\_\_\_\_

Printed Name/Signature

Tel. No./Cellphone No.

Date



Republic of the Philippines  
**CARLOS HILADO MEMORIAL STATE UNIVERSITY**  
 Talisay City, Negros Occidental  
 Mobile Phone Number: (0920) 583 3046  
[bac.sec@chmsu.edu.ph](mailto:bac.sec@chmsu.edu.ph)

## REQUEST FOR QUOTATION

Page 11 of 11

Date: APRIL 7, 2026  
 Quotation No. 26-109

Please quote your lowest price on the item/s listed below, stating the shortest time of delivery and submit your quotation duly signed by your representative not later than \_\_\_\_\_ in the return envelope attached herewith.

*(Signature)*  
 DR. MA. RIZA T. MANALO  
 BAC Chairperson

**NOTE:**

1. ALL ENTRIES MAY BE TYPEWRITTEN OR LEGIBLY HANDWRITTEN
2. DELIVERY PERIOD WITHIN 90 CALENDAR DAYS
3. WARRANTY SHALL BE FOR A PERIOD OF SIX (6) MONTHS FOR SUPPLIES & MATERIALS, ONE (1) YEAR FOR EQUIPMENT, FROM DATE OF ACCEPTANCE BY THE PROCURING ENTITY
4. PRICE VALIDITY SHALL BE FOR A PERIOD OF \_\_\_\_\_ CALENDAR DAYS
5. G-EPS REGISTRATION CERTIFICATE SHALL BE ATTACHED UPON SUBMISSION OF THE QUOTATION
6. BIDDERS SHALL SUBMIT ORIGINAL BROCHURES SHOWING CERTIFICATIONS OF THE PRODUCT BEING OFFERED

ITEM NO.	DESCRIPTION OF WORKS	QTY.	UNIT	MATERIAL COST		LABOR COST		TOTAL COST
				Unit Cost	Material Sub-Total Cost	Unit Cost	Labor Sub-Total Cost	
6.00	<b>MISCELLANEOUS WORKS</b>							
6.1	<b>FOR ALL OTHER ITEMS</b> that are not included on listed Bill of Quantities in your Bid but are deemed necessary for the completion of the works and the delivery of the project.	1.00	lot					
	<b>Sub-total, 6.0 (MISCELLANEOUS WORKS)</b>							
	PROJECT DURATION: 90 CALENDAR DAYS							
	Note: Attach Certificate of Site Inspection							
	<b>A. TOTAL DIRECT COST</b>							
	<b>B. CONSUMABLES:</b>							
	<b>C. SUPERVISION AND ADMINISTRATION:</b>							
	<b>D. TOTAL INDIRECT COST (B+C):</b>							
	<b>E. TOTAL COST (A+D)</b>							
	<b>F. VAT (12% OF ITEM E):</b>							
	<b>GRAND TOTAL OF PROJECT COST:</b>							
	<b>*****NOTHING FOLLOWS*****</b>							
	<b>TOTAL ABC = Php 900,000.00</b>							
	<b>PROCUREMENT OF LABOR AND MATERIALS FOR THE ENHANCEMENT OF FACULTY ROOM (WITH FACULTY LOUNGE AND ENHANCEMENT OF RESTROOM) - BINALBAGAN CAMPUS/ A.M.A. PANCHO (GAD Director)</b>							
	<b>PR# 26-211-0324 03-24-26</b>							
	<b>MDS 102-101-26-03 03-24-26</b>							

Released (BAC) \_\_\_\_\_ Date \_\_\_\_\_  
 Returned (Supplier) \_\_\_\_\_ By \_\_\_\_\_

\_\_\_\_\_  
 Printed Name/Signature  
 \_\_\_\_\_  
 Tel. No./Cellphone No.  
 \_\_\_\_\_  
 Date

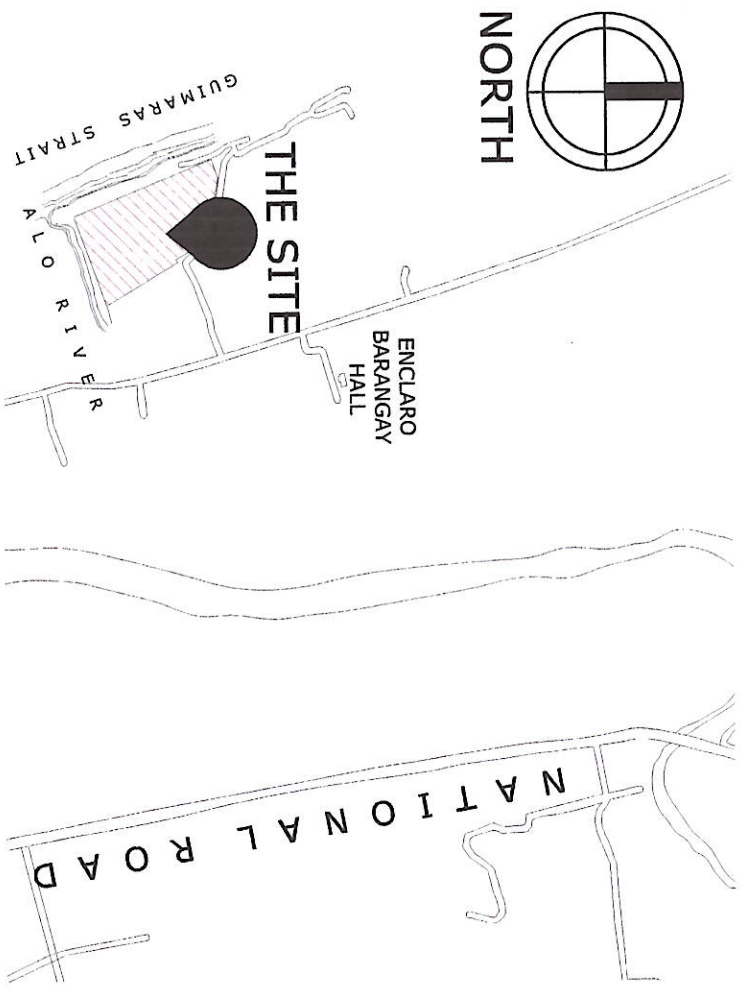

1 SITE VICINITY MAP  
SCALE NOT TO SCALE

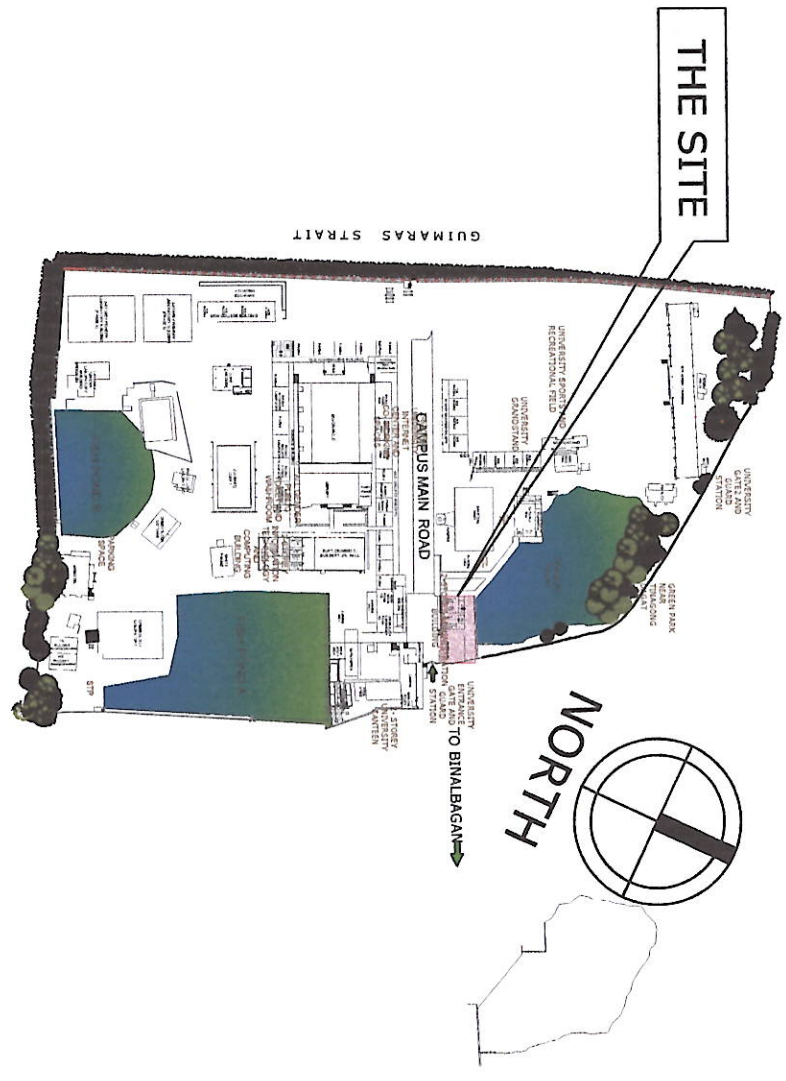

2 SITE DEVELOPMENT PLAN  
SCALE NOT TO SCALE

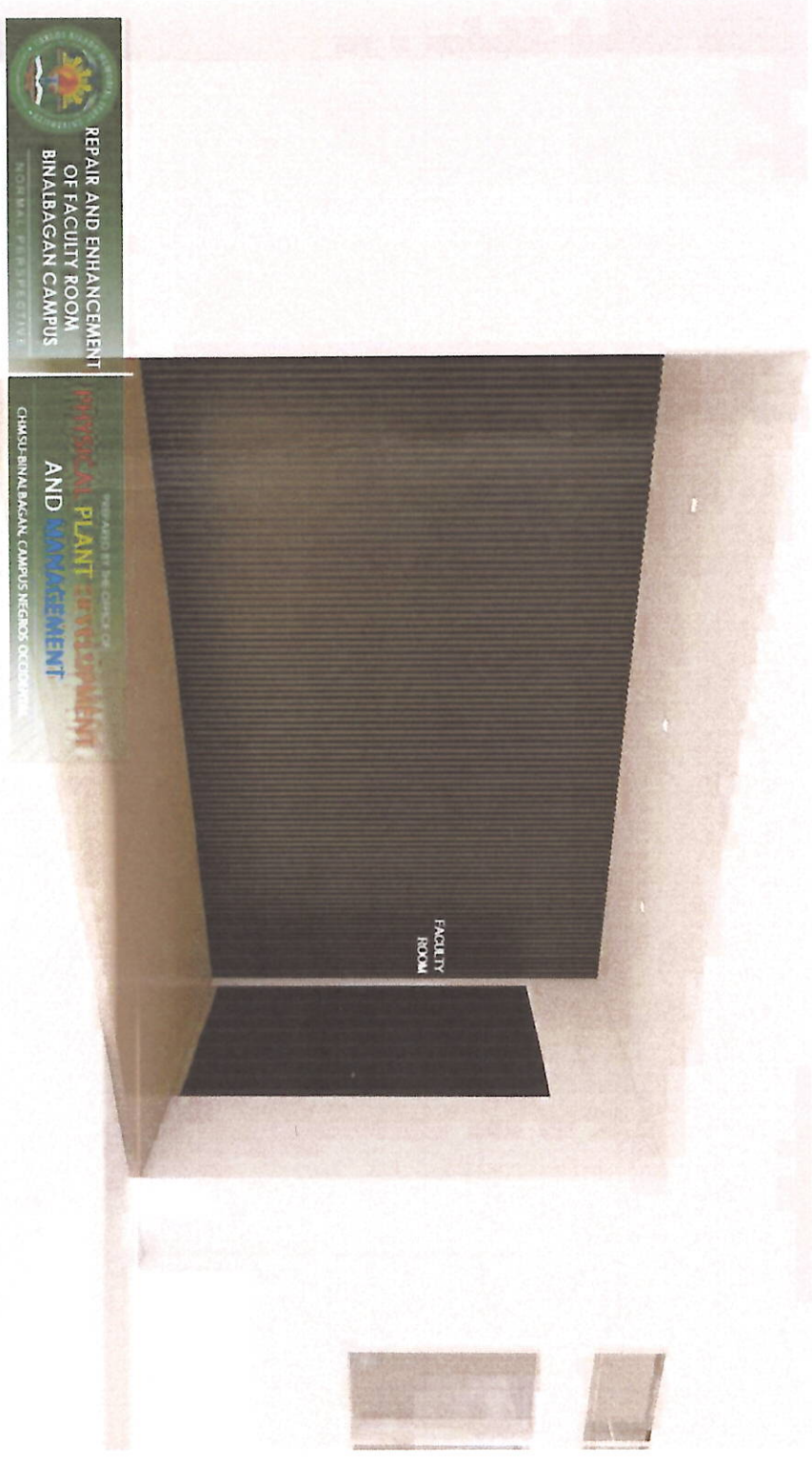

REPAIR AND ENHANCEMENT OF FACILITY ROOM BINALBAGAN CAMPUS  
CHMSU-BINALBAGAN, CAMPUS NEGROS OCCIDENTAL

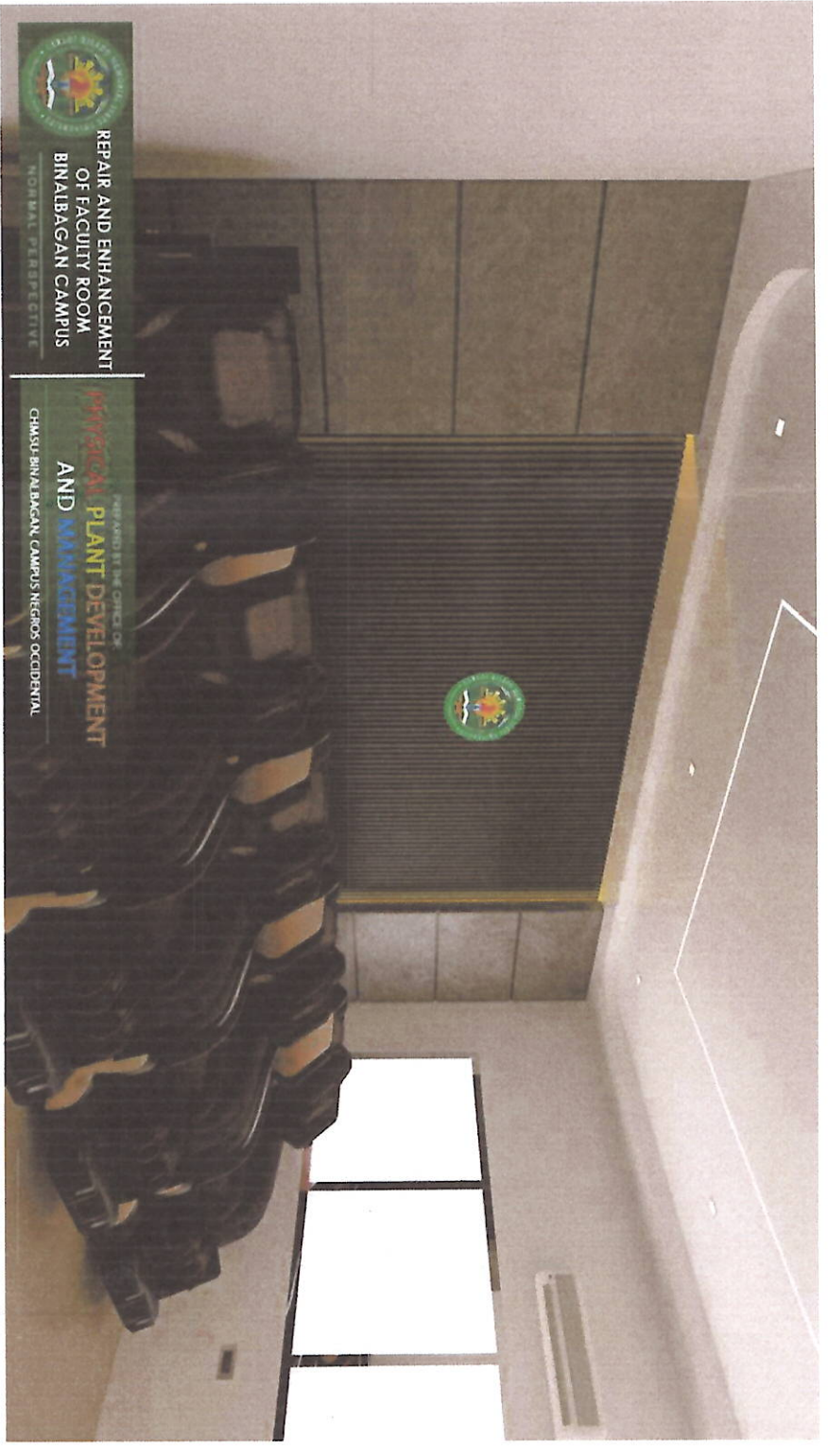

REPAIR AND ENHANCEMENT OF FACILITY ROOM BINALBAGAN CAMPUS  
CHMSU-BINALBAGAN, CAMPUS NEGROS OCCIDENTAL

3 PERSPECTIVE  
SCALE NOT TO SCALE





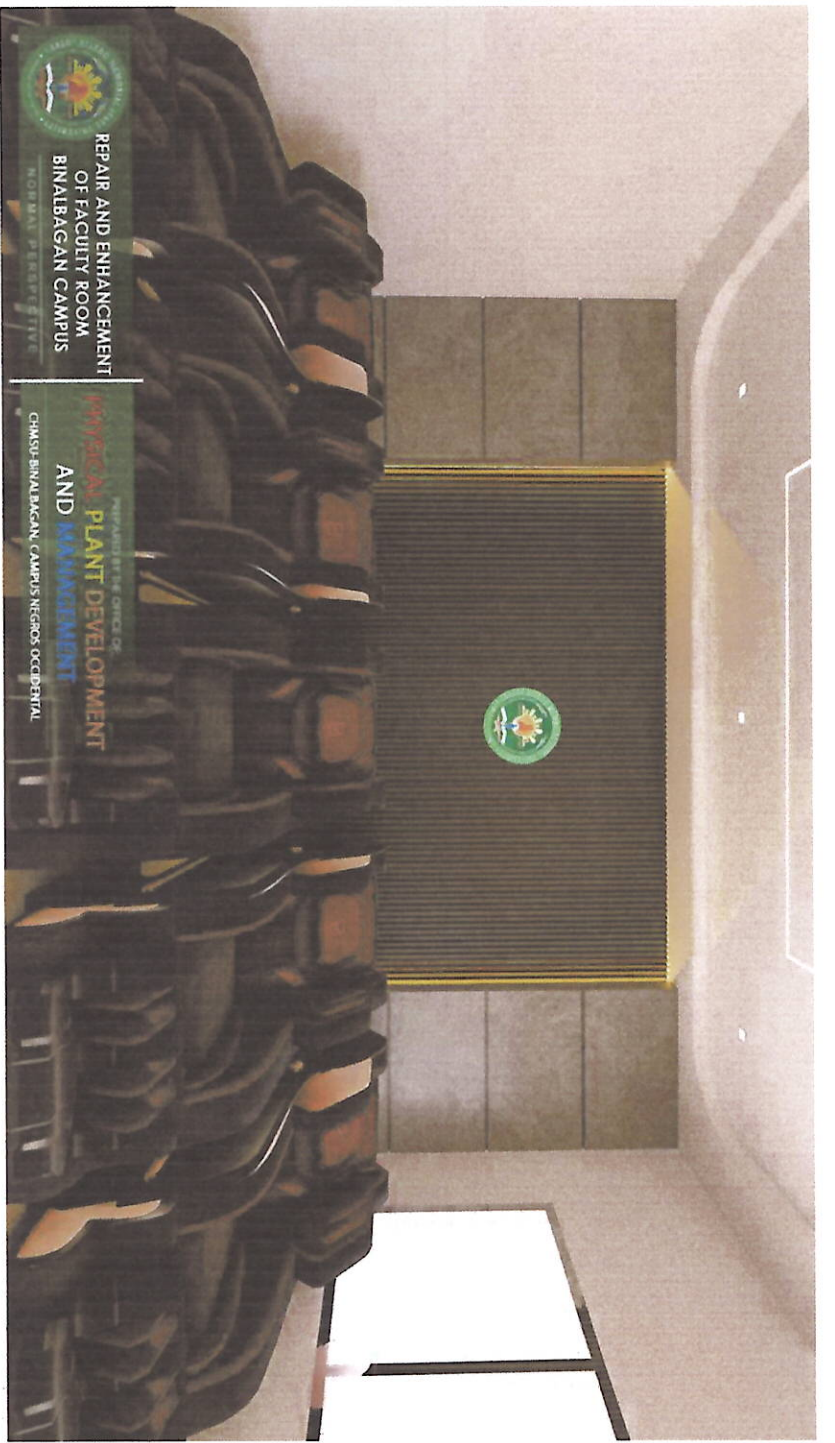

TABLE OF CONTENTS

SHEET	TITLE
ARCHITECTURAL	
CS	SITE VICINITY MAP
CS	SITE DEVELOPMENT MAP
CS	PERSPECTIVE
A-1	INTERIOR PERSPECTIVE
A-2	REMOVAL/DEMOLITION OF EXISTING STRUCTURE
A-3	EXISTING FLOOR PLAN
A-4	PROPOSED FLOOR PLAN
A-5	1. SECTION THRU- AA
	2. SECTION THRU- BB
	3. SECTION THRU- CC
	4. SECTION THRU- DD
	5. SECTION THRU- EE
A-6	1. CEILING LAYOUT PLAN
	2. FLOOR TILES
	3. HARDFLEX AND METAL
	4. FURNING BLOW-UP PLAN
	5. SCHEDULE OF DOORS
	6. AND WINDOW
A-7	1. KEY FLOOR PLAN
	2. BLOW-UP PROPOSED FLOOR PLAN
	3. WALL COVER-UP DETAIL
	4. SCHEDULE OF WALL AND FLOOR FINISHES
	ELECTRICAL
E1	1. GENERAL NOTES
	2. VICINITY MAP
	3. LEGEND
	4. SINGLE LINE DIAGRAM
	5. LIGHTING LAYOUT PLAN
	6. POWER LAYOUT PLAN
	PLUMBING
P1	1. GENERAL NOTES
	2. VICINITY MAP
	3. LEGEND
	4. SANITARY LINE LAYOUT PLAN
	5. WATER LINE LAYOUT PLAN
	6. PLUMBING ISOMETRIC LAYOUT PLAN

<p>Republic of the Philippines CARLOS HILADO MEMORIAL STATE UNIVERSITY Negros Occidental</p>		<p>PROJECT TITLE: REPAIR AND ENHANCEMENT OF FACILITY ROOM AT CHMSU-BINALBAGAN CAMPUS</p>		<p>ENDORSED BY: JOVELLE B. VERGARA, EDD. EXECUTIVE DIRECTOR, BINALBAGAN</p>		<p>PREPARED BY: MALDONADO M. VILLATURRA DRAFTSMAN, PMU - BINALBAGAN CAMPUS ENGR. JOHN CARLO F. GANON CIVIL ENGINEER, PMU - BINALBAGAN CAMPUS</p>		<p>CHECKED BY: [Signature] PROJECT DEVELOPMENT OFFICER II, PMU ENGR. JESIRE O. CHAVEZ PROJECT DEVELOPMENT OFFICER III, PMU</p>		<p>RECOMMENDING APPROVAL: ENGR. JIN-JUN J. MARQUEZ DIRECTOR, PROJECT MANAGEMENT UNIT</p>		<p>APPROVED BY: NORBERTO P. MANGULABNAN, Ph.D. SIC PRESIDENT III</p>		<p>SHEET NO.: PAGE NO.: <b>CS</b> <b>S</b></p>	
<p>PROJECT MANAGEMENT UNIT</p>		<p>PROJECT LOCATION: BINALBAGAN CAMPUS</p>		<p>CIVIL ENGINEER, PMU - BINALBAGAN CAMPUS</p>		<p>PROJECT DEVELOPMENT OFFICER III, PMU</p>		<p>DIRECTOR, PROJECT MANAGEMENT UNIT</p>		<p>SIC PRESIDENT III</p>		<p>SHEET NO.: PAGE NO.: <b>CS</b> <b>S</b></p>			



**1**  
SCALE  
**AI1**  
SCALE  
**INTERIOR PERSPECTIVE**  
NOT TO SCALE

 Republic of the Philippines <b>CARLOS HILADO MEMORIAL STATE UNIVERSITY</b> Negros Occidental	<b>PROJECT TITLE:</b> REPAIR AND ENHANCEMENT OF FACULTY ROOM AT CHMSU-BINALBAGAN CAMPUS	<b>ENDORSED BY:</b>  JOEVELLE B. BERGARA, EDD. EXECUTIVE DIRECTOR, BINALBAGAN	<b>PREPARED BY:</b>  MALE ENILA M. VILLATURRA DRA. ENILA M. VILLATURRA ENGR. JOHN CARLO F. GANON CIVIL ENGINEER, PMU - BINALBAGAN CAMPUS	<b>CHECKED BY:</b>  ANFER M. S. SULAT, UEP PROJECT DEVELOPMENT OFFICER II, PMU ENGR. DESIRE O. CHAVEZ PROJECT DEVELOPMENT OFFICER III, PMU	<b>RECOMMENDING APPROVAL:</b>  R. JUN J. MARQUEZ DIRECTOR, PROJECT MANAGEMENT UNIT	<b>APPROVED BY:</b>  JAY B. ESTRELLA, EDD. OIC - VICE PRESIDENT FOR ADMINISTRATION AND FINANCE	<b>APPROVED BY:</b>  NORBERTO P. MANGULABNAN, Ph.D. SUC PRESIDENT/II	<b>SHEET NO:</b> <b>A</b>	<b>PAGE NO:</b> <b>1</b> <b>7</b>
--	--	--	--	--	--	--	--	------------------------------	---



MAIN DOORS AND WINDOW



EXIT DOOR AND WINDOW



FLOOR TILES AND WINDOW



MALE AND FEMALE TOILET

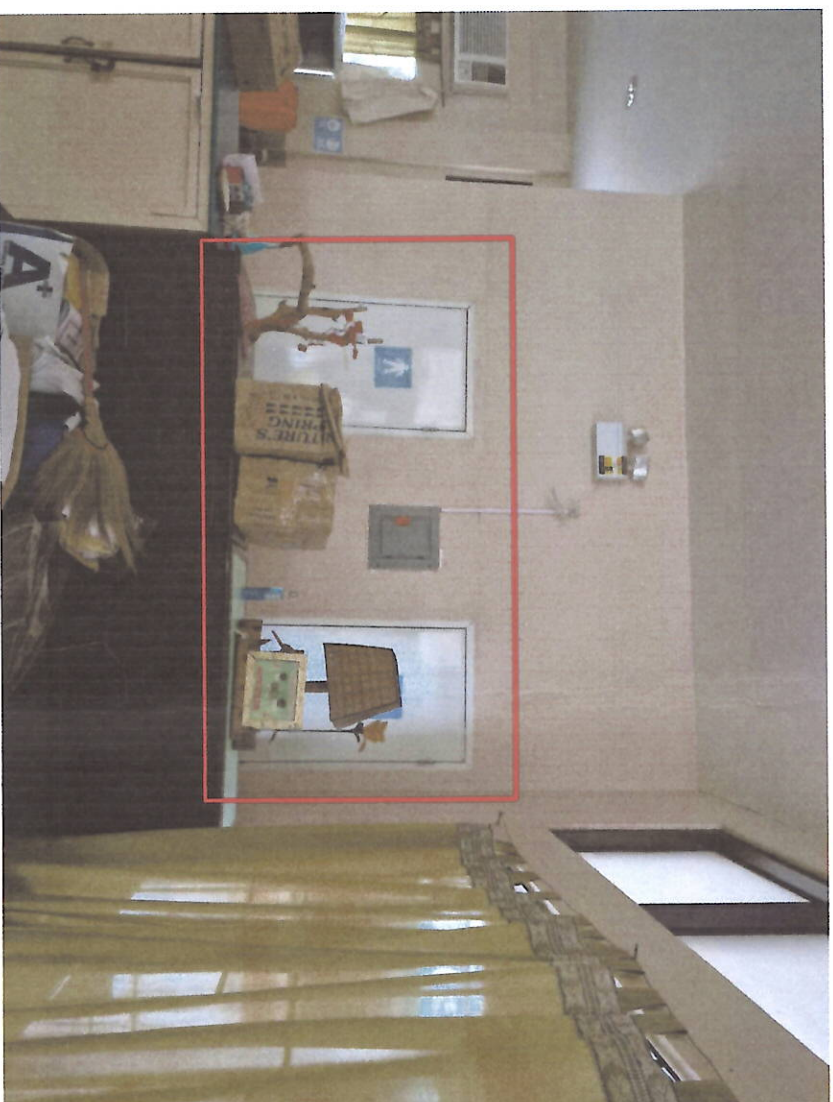

LOCATION OF PANEL BOARD











PANTRY AREA



REMOVAL/DEMOLITION OF EXISTING STRUCTURE



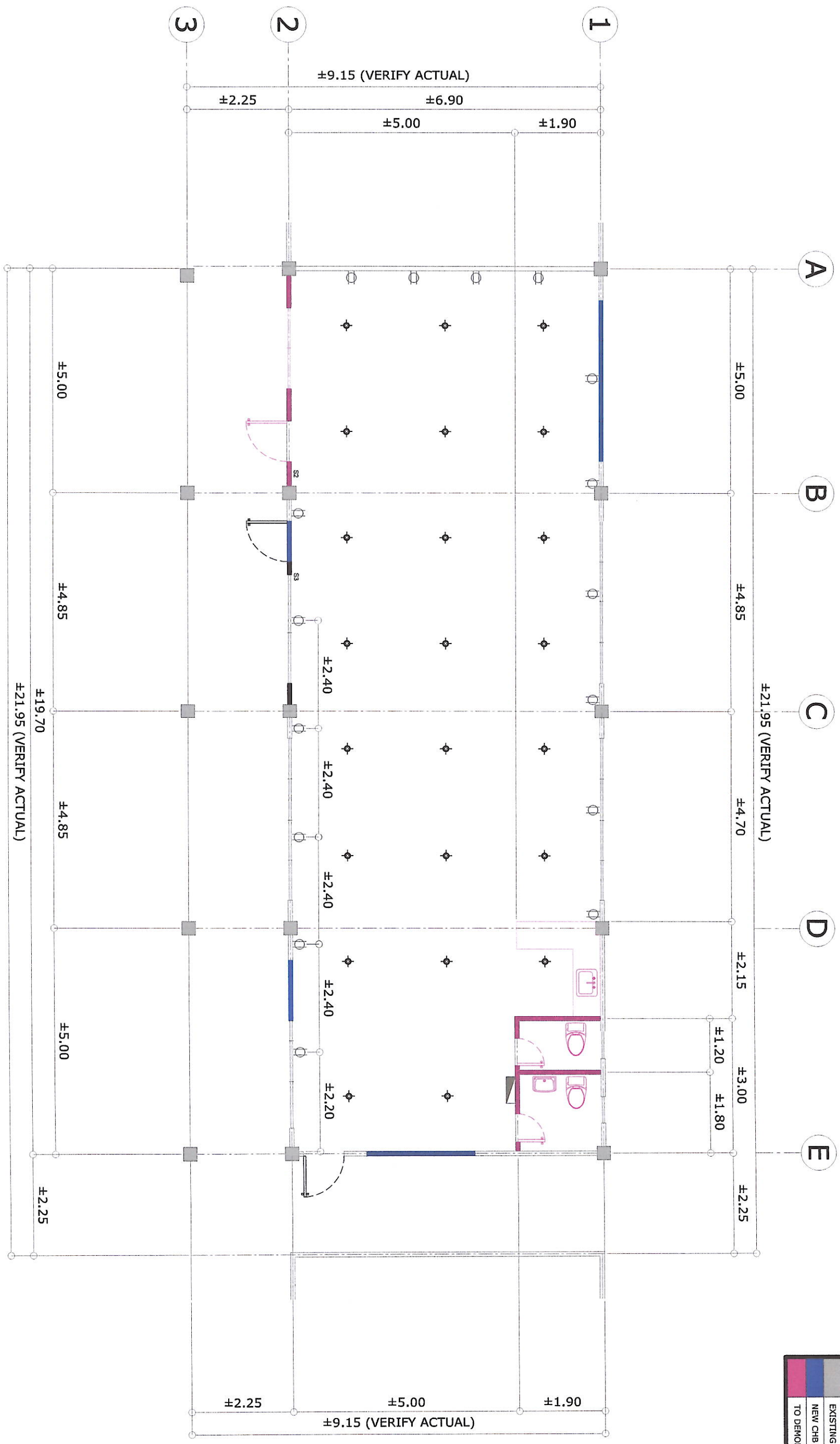

NOT TO SCALE

 Republic of the Philippines <b>CARLOS HILADO MEMORIAL STATE UNIVERSITY</b> Negros Occidental		<b>PROJECT TITLE:</b> REPAIR AND ENHANCEMENT OF FACULTY ROOM AT CHMSU-BINALBAGAN CAMPUS		<b>ENDORSED BY:</b>  JOEVEL B. VERGARA, E.D. EXECUTIVE DIRECTOR, BINALBAGAN	
<b>PROJECT LOCATION:</b> BINALBAGAN CAMPUS		<b>PREPARED BY:</b>  MA LECHILA M. VILATURRA DRAFTSMAN, PMU - BINALBAGAN CAMPUS  ENGR. JOHN CARLO F. GANON CIVIL ENGINEER, PMU - BINALBAGAN CAMPUS		<b>CHECKED BY:</b>  ENGR. DESIRE O. CHAVEZ PROJECT DEVELOPMENT OFFICER II, PMU	
<b>RECOMMENDING APPROVAL:</b>  ENGR. JUN-JUN J. MARQUEZ DIRECTOR, PROJECT MANAGEMENT UNIT		<b>APPROVED BY:</b>  JAY B. ESTIVALDAS, E.D. OIC - VICE PRESIDENT FOR ADMINISTRATION AND FINANCE		<b>APPROVED BY:</b>  NORBERTO P. MANGULABNAN, Ph.D. SUC PRESIDENT III	
<b>PROJECT MANAGEMENT UNIT</b>		<b>SHEET NO:</b> A		<b>PAGE NO:</b> 2/7	

HATCH LEGEND	
	EXISTING CHB WALL
	EXISTING COLUMN
	NEW CHB 4" WALL
	TO DEMOLISH

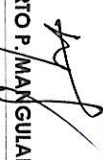

**1**  
**A3**  
 SCALE  
**EXISTING GROUND FLOOR PLAN**  
 1:85 METERS

 Republic of the Philippines <b>CARLOS HILADO MEMORIAL STATE UNIVERSITY</b> Negros Occidental		<b>PROJECT TITLE:</b> REPAIR AND ENHANCEMENT OF FACILITY ROOM AT CHMSU-BINALBAGAN CAMPUS		<b>ENDORSED BY:</b>  JOEVELLE B. VERGARA, EDD. EXECUTIVE DIRECTOR, BINALBAGAN		<b>PREPARED BY:</b>  MALEONIA M. VILLATURBA DRAFTSMAN, PMU - BINALBAGAN CAMPUS ENGR. JOHN CARLO F. GANON CIVIL ENGINEER, PMU - BINALBAGAN CAMPUS		<b>CHECKED BY:</b>  ANA ARNELL M. ISILAL PROJECT DEVELOPMENT OFFICER II, PMU ENGR. DESIRE O. CHAVEZ PROJECT DEVELOPMENT OFFICER III, PMU		<b>RECOMMENDING APPROVAL:</b>  ENGR. JUN J. MARGOZ DIRECTOR, PROJECT MANAGEMENT UNIT		<b>APPROVED BY:</b>  NORBERTO P. MANGULABNAN, Ph.D. SUC PRESIDENT III		<b>SHEET NO:</b> <b>A</b>		<b>PAGE NO:</b> <b>3</b> <b>7</b>	
<b>PROJECT MANAGEMENT UNIT</b>		<b>PROJECT LOCATION: BINALBAGAN CAMPUS</b>		<b>CIVIL ENGINEER, PMU - BINALBAGAN CAMPUS</b>		<b>PROJECT DEVELOPMENT OFFICER III, PMU</b>		<b>DIRECTOR, PROJECT MANAGEMENT UNIT</b>		<b>SUC PRESIDENT III</b>							

HATCH LEGEND	
	EXISTING CHB WALL
	EXISTING COLUMN
	NEW 12MM THICK FIBER CEMENT WALL
	NEW CHB 4" WALL

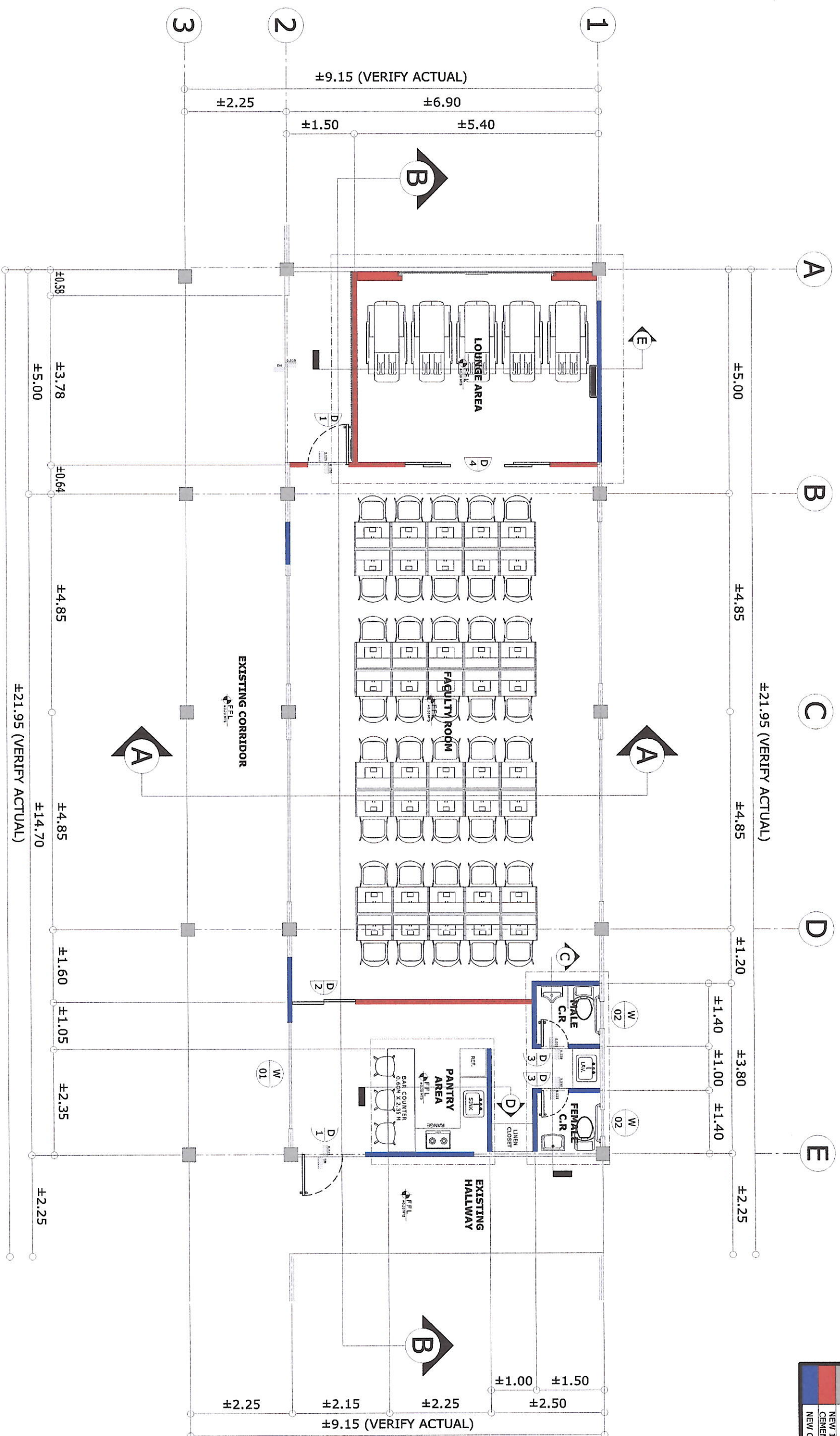

**1**  
A/4  
SCALE  
**PROPOSED GROUND FLOOR PLAN**  
1:85 METERS

<p>Republic of the Philippines CARLOS HILADO MEMORIAL STATE UNIVERSITY Negros Occidental</p>		<p><b>PROJECT TITLE:</b> REPAIR AND ENHANCEMENT OF FACILITY ROOM AT CHMSU-BINALBAGAN CAMPUS</p>		<p><b>ENDORSED BY:</b>  EXECUTIVE DIRECTOR, BINALBAGAN</p>		<p><b>PREPARED BY:</b>  DRAFTSMAN, PMU - BINALBAGAN CAMPUS</p>		<p><b>CHECKED BY:</b>  PROJECT DEVELOPMENT OFFICER II, PMU</p>		<p><b>RECOMMENDING APPROVAL:</b>  DIRECTOR, PROJECT MANAGEMENT UNIT</p>		<p><b>APPROVED BY:</b>  SUC PRESIDENT III</p>		<p><b>SHEET NO:</b> A <b>PAGE NO:</b> 4/7</p>	
<p><b>PROJECT MANAGEMENT UNIT</b></p>		<p><b>PROJECT LOCATION:</b> BINALBAGAN CAMPUS</p>		<p><b>EXECUTIVE DIRECTOR, BINALBAGAN</b> JOVELLE B. VERGARA, EDD.</p>		<p><b>MASSON VILLATURRA</b> DRAFTSMAN, PMU - BINALBAGAN CAMPUS</p>		<p><b>ENGR. DENISE O. CHAVEZ</b> PROJECT DEVELOPMENT OFFICER III, PMU</p>		<p><b>JAY B. ESTRELLAS, EDD.</b> DIR. - VICE PRESIDENT FOR ADMINISTRATION</p>		<p><b>NORBERTO P. MANGILABNAN, Ph.D.</b> SUC PRESIDENT III</p>		<p><b>A</b> <b>4</b> <b>7</b></p>	



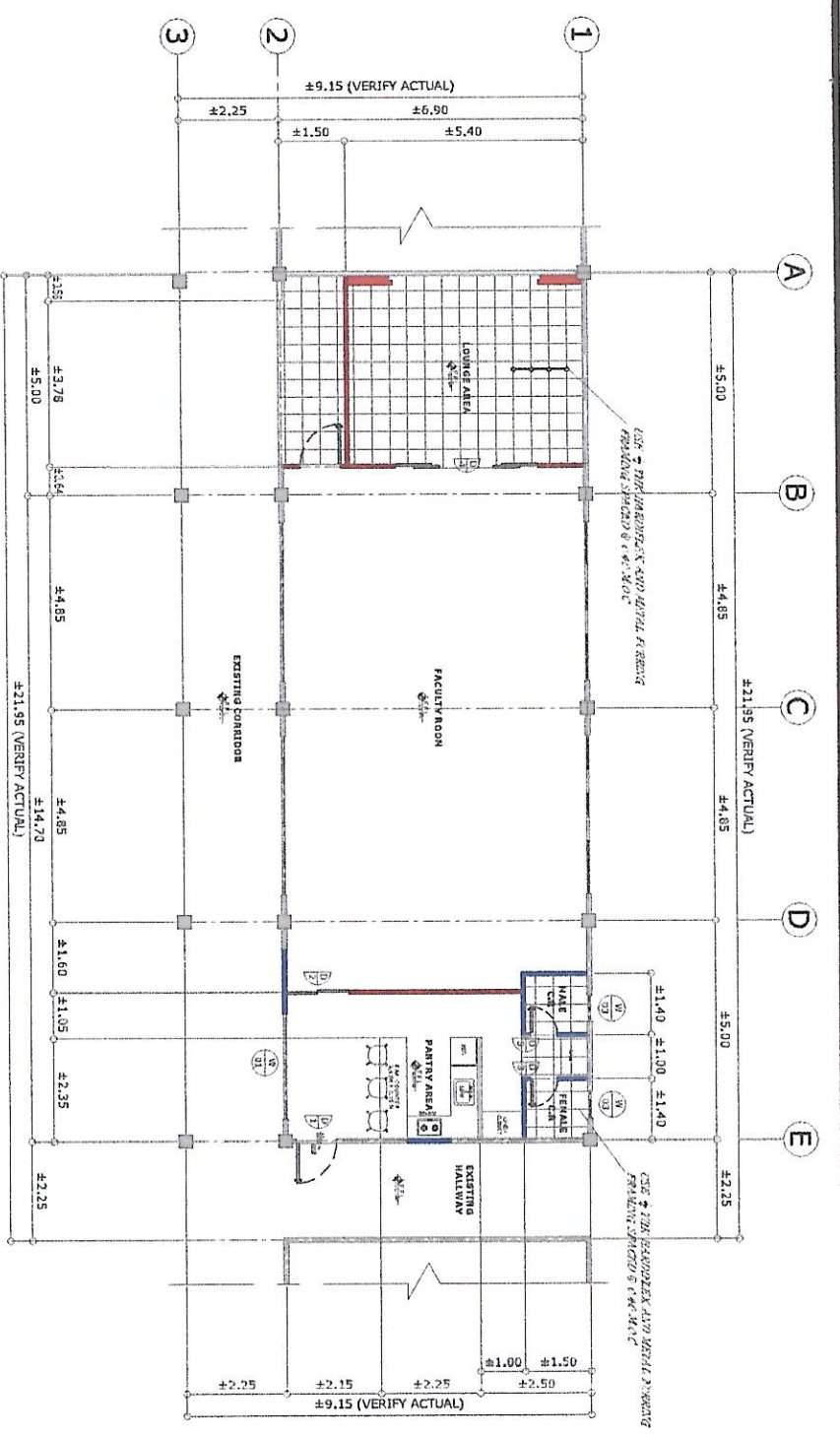

**1** CEILING LAYOUT PLAN  
SCALE 1:165 METERS

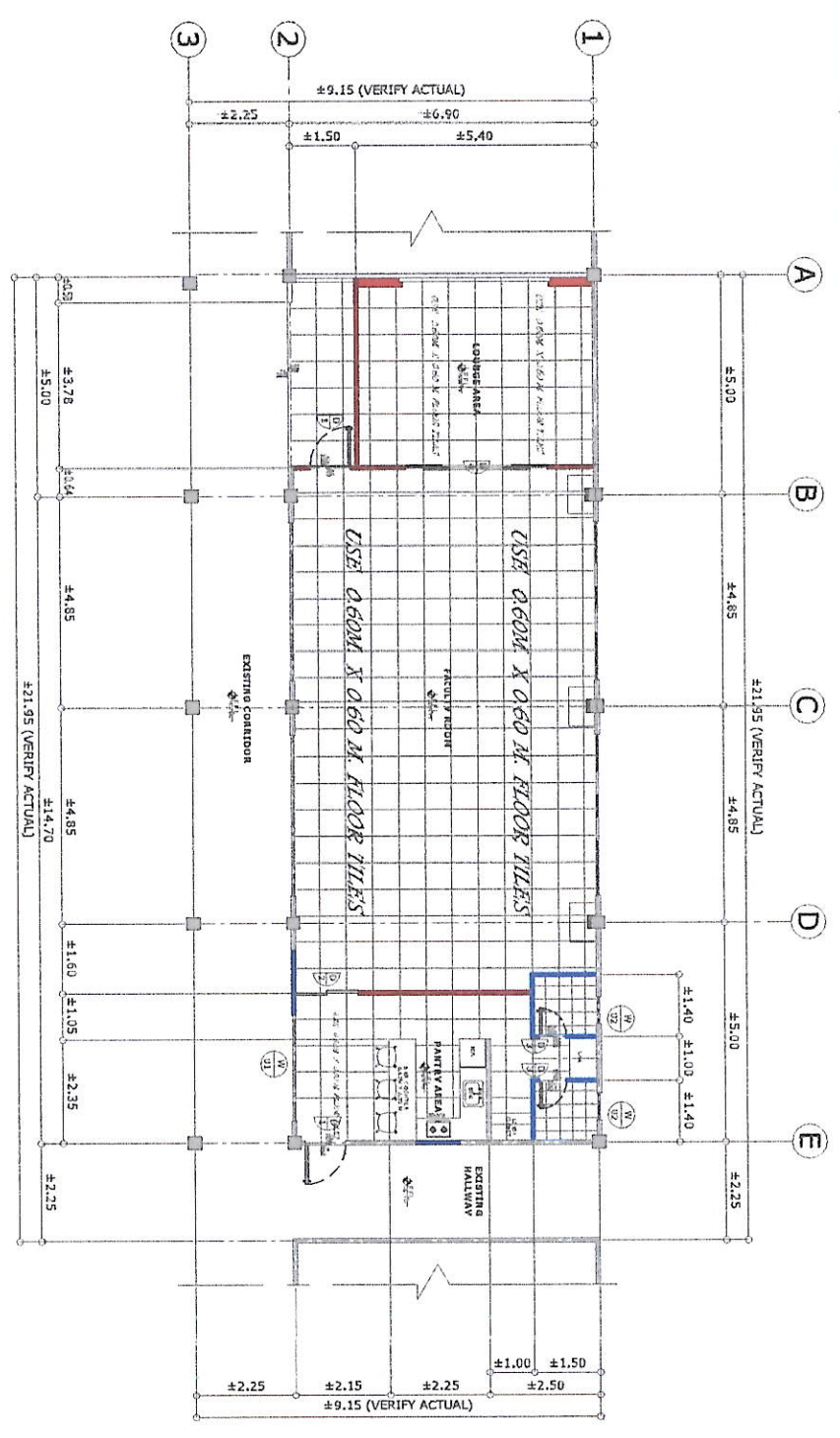

**2** FLOOR TILES LAYOUT PLAN  
SCALE 1:165 METERS

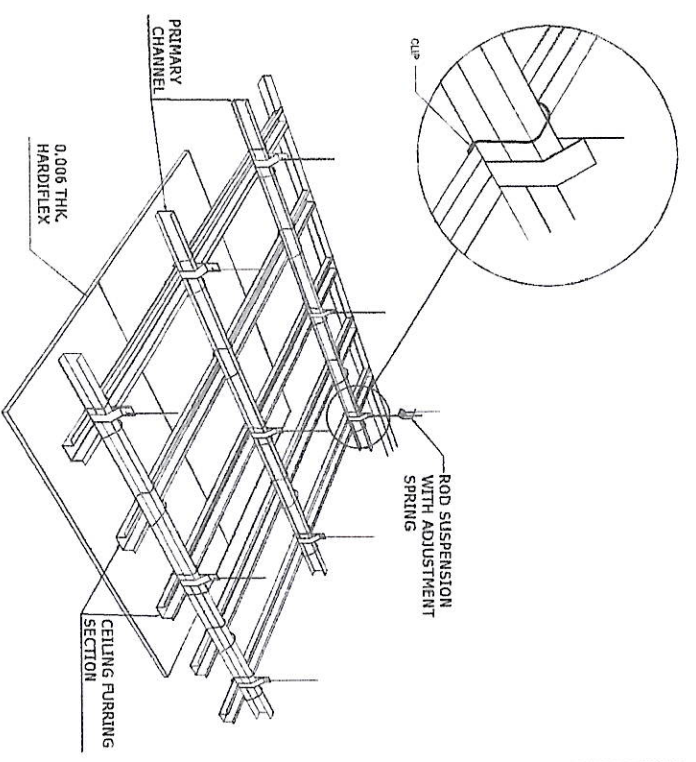

**3** BLOW-UP DETAIL PLAN  
SCALE NOT TO SCALE

PLAN VIEW:	PLAN VIEW:	PLAN VIEW:	PLAN VIEW:	PLAN VIEW:	PLAN VIEW:
<b>D DOOR-1</b>	<b>D DOOR-2</b>	<b>D DOOR-3</b>	<b>D DOOR-4</b>	<b>W WINDOW-1</b>	<b>W WINDOW-2</b>
LOCATION: MAIN AND EXIT DOOR	LOCATION: PANTRY AREA	LOCATION: MALE AND FEMALE TOILET	LOCATION: LOUNGE AREA	LOCATION: PANTRY AREA	LOCATION: MALE AND FEMALE TOILET
SIZE: 1.00 M X 2.19 M	SIZE: 1.40 M X 2.10 M	SIZE: 0.70 M X 2.10 M	SIZE: 3.20 M X 2.80 M	SIZE: 2.40 M X 1.20 M	SIZE: 0.80 M X 0.80
NO. OF PANELS: 1	NO. OF PANELS: 2	NO. OF PANELS: 1	NO. OF PANELS: 4	NO. OF PANELS: 2	NO. OF PANELS: 1
NO. OF UNITS: 2	NO. OF UNITS: 1	NO. OF UNITS: 2	NO. OF UNITS: 1	NO. OF UNITS: 1	NO. OF UNITS: 2
MATERIALS: WOOD PANEL	MATERIALS: GLASS & ALUMINUM W/ 7" THK GLASS	MATERIALS: POLYVINYL CHLORIDE (PVC)	MATERIALS: GLASS & ALUMINUM W/ 7" THK GLASS	MATERIALS: GLASS & ALUMINUM W/ 7" THK GLASS	MATERIALS: GLASS & ALUMINUM W/ 7" THK GLASS
TYPE: PANEL DOOR	TYPE: SLIDING DOOR	TYPE: PANEL DOOR	TYPE: SLIDING DOOR WITH TRANSOM	TYPE: SLIDING WINDOW	TYPE: AWNING WINDOW

**4** SCHEDULE OF DOORS AND WINDOWS  
SCALE 1:100 METERS

Republic of the Philippines  
CARLOS ALADO MEMORIAL  
STATE UNIVERSITY  
Negros Occidental

PROJECT MANAGEMENT UNIT

PROJECT TITLE:  
REPAIR AND ENHANCEMENT OF  
FACILITY ROOM AT  
CHMSU-BINALBAGAN CAMPUS

PROJECT LOCATION: BINALBAGAN CAMPUS

---

ENDORSED BY:

JOE VELLE B. VERGARA, EDD.  
EXECUTIVE DIRECTOR, BINALBAGAN

PREPARED BY:

MA. LEONIDA M. VILLATURRA  
DRAFTSMAN, ENR., BINALBAGAN CAMPUS

---

CHECKED BY:

AR. ENRIQUE M. DELA CRUZ, EDD.  
PROJECT DEVELOPMENT OFFICER III, PMU

RECOMMENDING APPROVAL:

EDER JUN J. MARQUEZ  
DIRECTOR, PROJECT MANAGEMENT UNIT

---

APPROVED BY:

NORBERTO P. MANGULABNAN, Ph.D.  
SUC PRESIDENT III

SHEET NO: PAGE NO:  
**A 6 / 7**

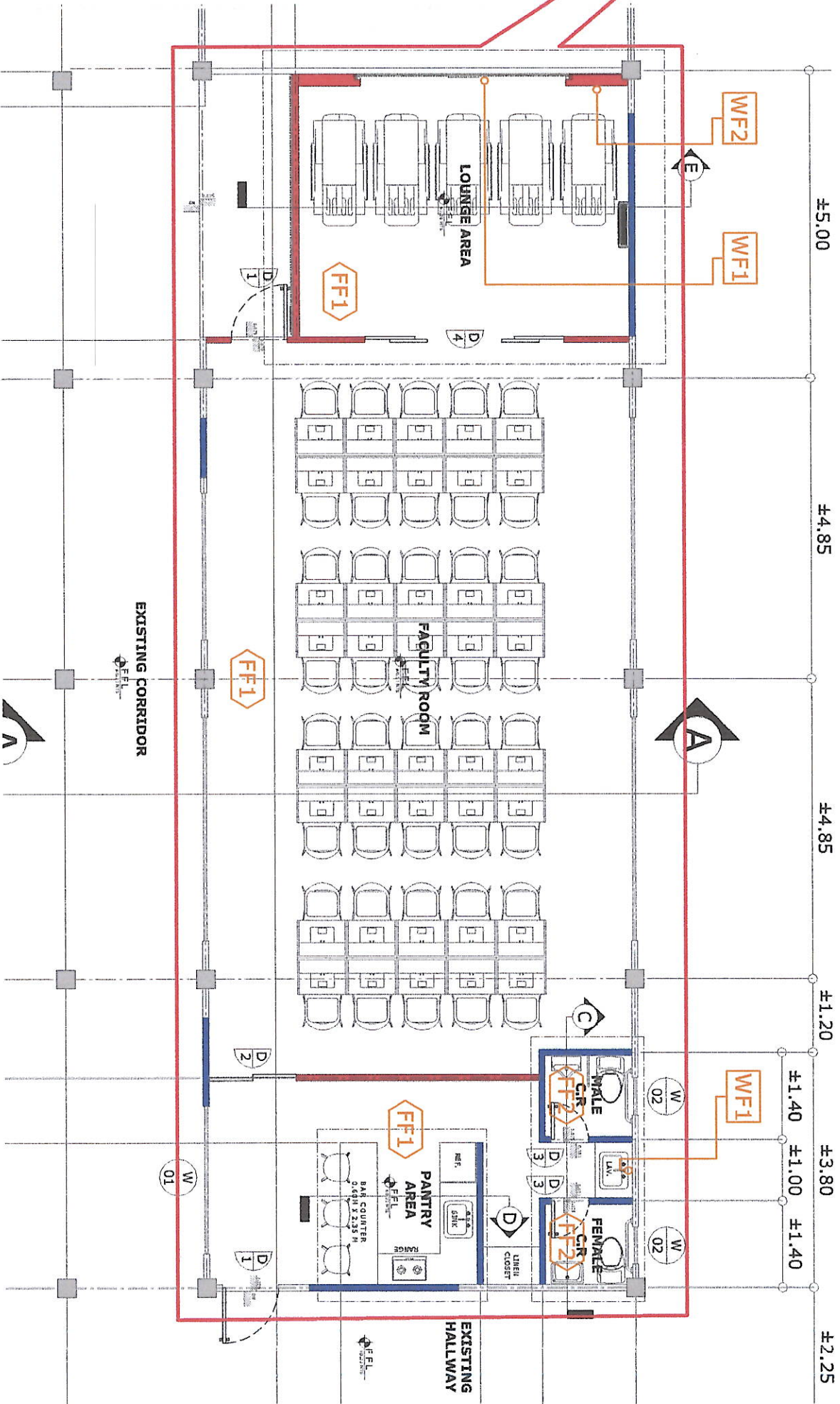
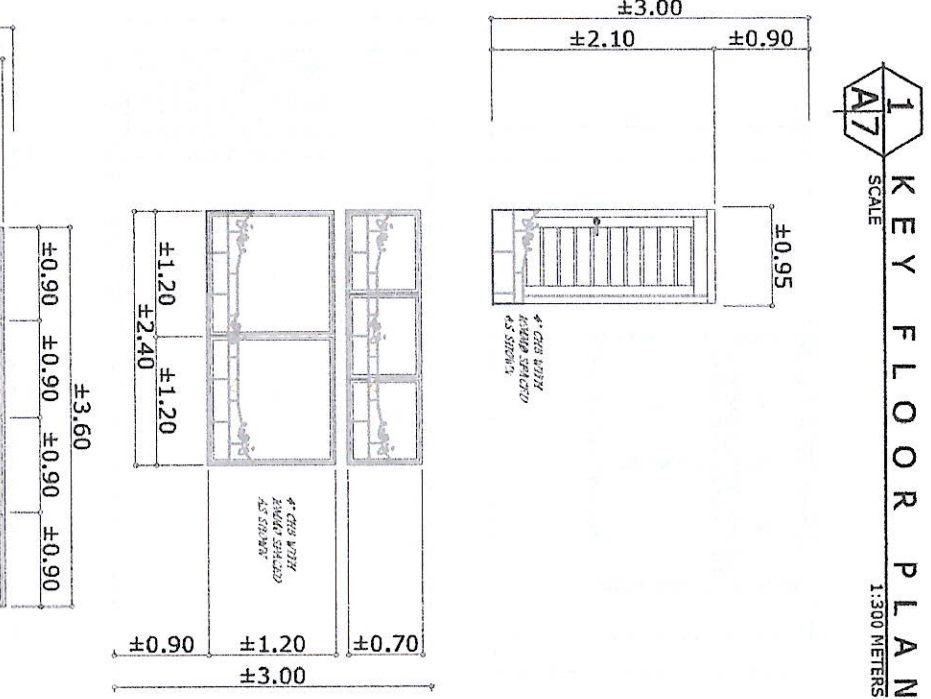
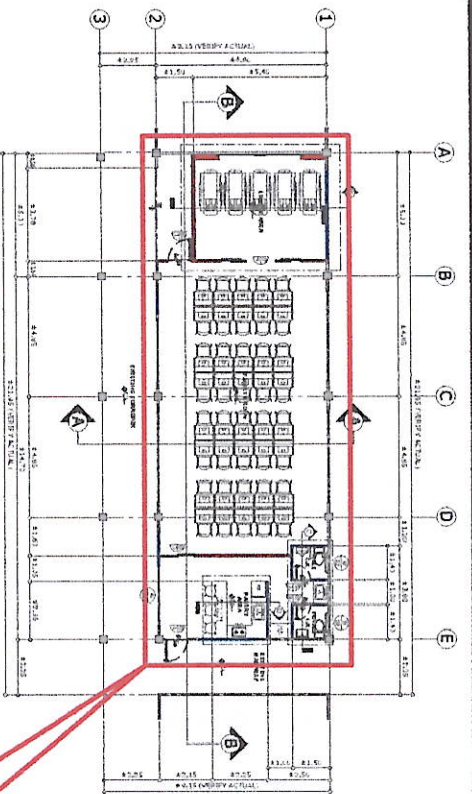

HATCH LEGEND	
[Red Hatch]	EXISTING CHB WALL
[Grey Hatch]	EXISTING COLUMN
[Blue Hatch]	NEW 12MM THICK FIBER CEMENT WALL
[Blue Hatch]	NEW CHB 4" WALL

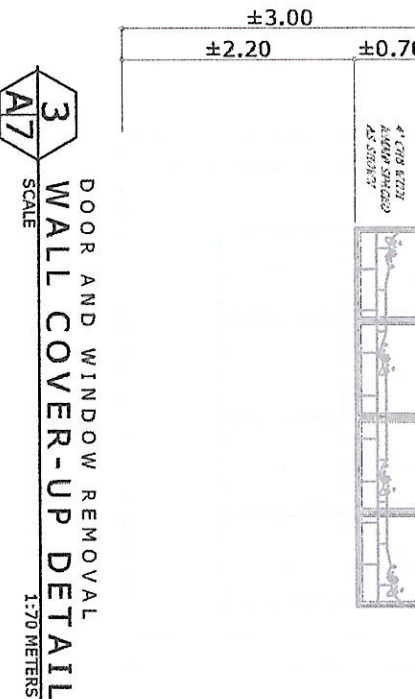

**2 BLOW-UP PROPOSED FLOOR PLAN**  
NOT TO SCALE

SCHEDULE OF WALL FINISHES	
CODE	DESCRIPTION
WF1	WALL FINISHED 1 (WALL ACCENT)
WF2	INDOOR FLUTED PANEL (WOOD COMPOSITE MATERIAL) AND 12MM THICK FIBER BOARD AS BACKING (VERIFY PDDM OFFICE)
WF2	WALL FINISHED 2 (WALL ACCENT)
WF2	CONCRETE WALL CLADDING

SCHEDULE OF FLOOR FINISHES	
CODE	DESCRIPTION
FF1	FLOOR FINISHED 1
FF1	60X60 FLOOR TILES OR ANY EQUIVALENT MATERIAL (VERIFY PDDM OFFICE)
FF2	FLOOR FINISHED 2
FF2	30X30 FLOOR TILES OR ANY EQUIVALENT MATERIAL (VERIFY PDDM OFFICE)

PROJECT TITLE: REPAIR AND ENHANCEMENT OF FACILITY ROOM AT CHMSU-BINALBAGAN CAMPUS

ENDORSED BY: *[Signature]* EXECUTIVE DIRECTOR, BINALBAGAN

PREPARED BY: *[Signature]* MALEQJILA M. VILLATURA DRAFTSMAN, PMU - BINALBAGAN CAMPUS

CHECKED BY: *[Signature]* ANGEL W. SOLAN, PMP PROJECT DEVELOPMENT OFFICER II, PMU

RECOMMENDING APPROVAL: *[Signature]* ENGR. JUDY JUN J. MARQUEZ DIRECTOR, PROJECT MANAGEMENT UNIT

APPROVED BY: *[Signature]* NORBERTO P. MANGULABANAN, PH.D. SUC PRESIDENT III



Republic of the Philippines  
CARLOS HILADO MEMORIAL  
STATE UNIVERSITY  
Negros Occidental

PROJECT MANAGEMENT UNIT

PROJECT LOCATION: BINALBAGAN CAMPUS

PROJECT TITLE: REPAIR AND ENHANCEMENT OF FACILITY ROOM AT CHMSU-BINALBAGAN CAMPUS

ENDORSED BY: *[Signature]* EXECUTIVE DIRECTOR, BINALBAGAN

PREPARED BY: *[Signature]* MALEQJILA M. VILLATURA DRAFTSMAN, PMU - BINALBAGAN CAMPUS

CHECKED BY: *[Signature]* ANGEL W. SOLAN, PMP PROJECT DEVELOPMENT OFFICER II, PMU

RECOMMENDING APPROVAL: *[Signature]* ENGR. JUDY JUN J. MARQUEZ DIRECTOR, PROJECT MANAGEMENT UNIT

APPROVED BY: *[Signature]* NORBERTO P. MANGULABANAN, PH.D. SUC PRESIDENT III

SHEET NO: **A** / PAGE NO: **7** / **7**

**GENERAL NOTES:**

1. ALL WIRING INSTALLATIONS MUST CONFORM WITH THE LATEST REQUIREMENT OF THE PHILIPPINE ELECTRICAL CODE, NATIONAL BUILDING CODE, FIRE CODE OF THE PHILIPPINES AND THE REQUIREMENTS OF THE LOCAL ELECTRIC UTILITY.
2. THE SOURCE OF POWER IS FROM THE PROPOSED 1-UNIT 37.5 KVA, 1-PHASE, 13200/7620V, DISTRIBUTION TRANSFORMER, OIL-IMMERSED TAPPED FROM NOCECO 13200/7620 LINES.
3. SERVICE ENTRANCE WIRE SHALL BE 2-80MM SQ. THW & 1-22MM SQ. THW (GROUND) IN 50MM (2" DIA.) RMC.
4. MAIN BREAKER SHALL BE 175A, 2P, 240V BOLT-ON TYPE.
5. NO WIRE SMALLER THAN 3.5MM SQ. THHN WIRE SHALL BE USED.
6. ALL WIRING INSTALLATION MUST BE SUPERVISED BY AT LEAST A LICENSED MASTER ELECTRICIAN AND MONITORED BY AN REE OR PEE.
7. NO WORK SHALL STARTED WITHOUT APPROVED BUILDING PERMIT.
8. ALL WORK MUST BE DONE AS REFLECTED ON THE APPROVED ELECTRICAL PLANS.

**1 GENERAL NOTES**  
SCALE NOT TO SCALE

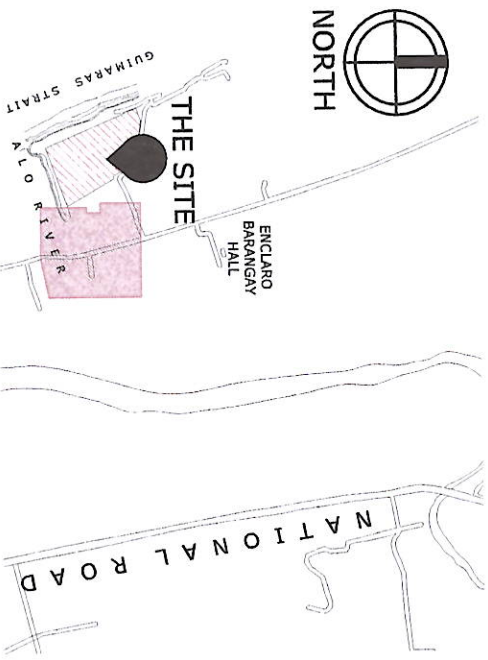

	ELECTRICAL WIRE
	SWITCH LINE
	PIN LIGHT
	PANEL BOARD
	CIRCUIT HOME RUN
	CONVENIENCE OUTLET
	SINGLE SWITCH
	TWO- GANG SWITCH
	THREE- GANG SWITCH
	WEATHER PROOF
	AIR CONDITION UNIT
	REFRIGERATOR
	EXHAUST FAN
	EMERGENCY LIGHT

**2 VICINITY PLAN**  
SCALE NOT TO SCALE

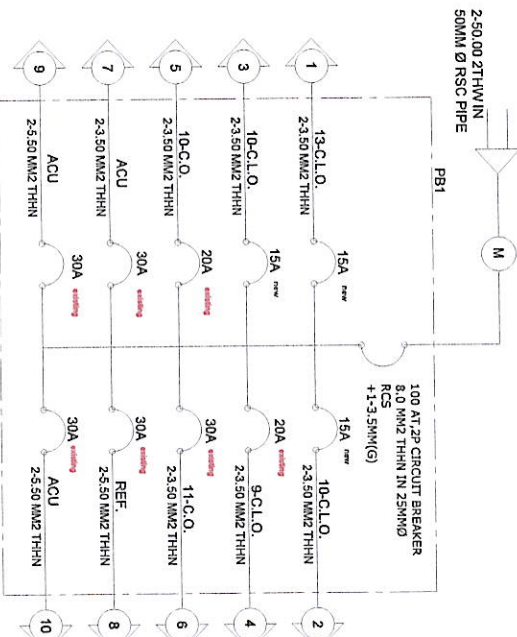

**3 LEGEND**  
SCALE NOT TO SCALE

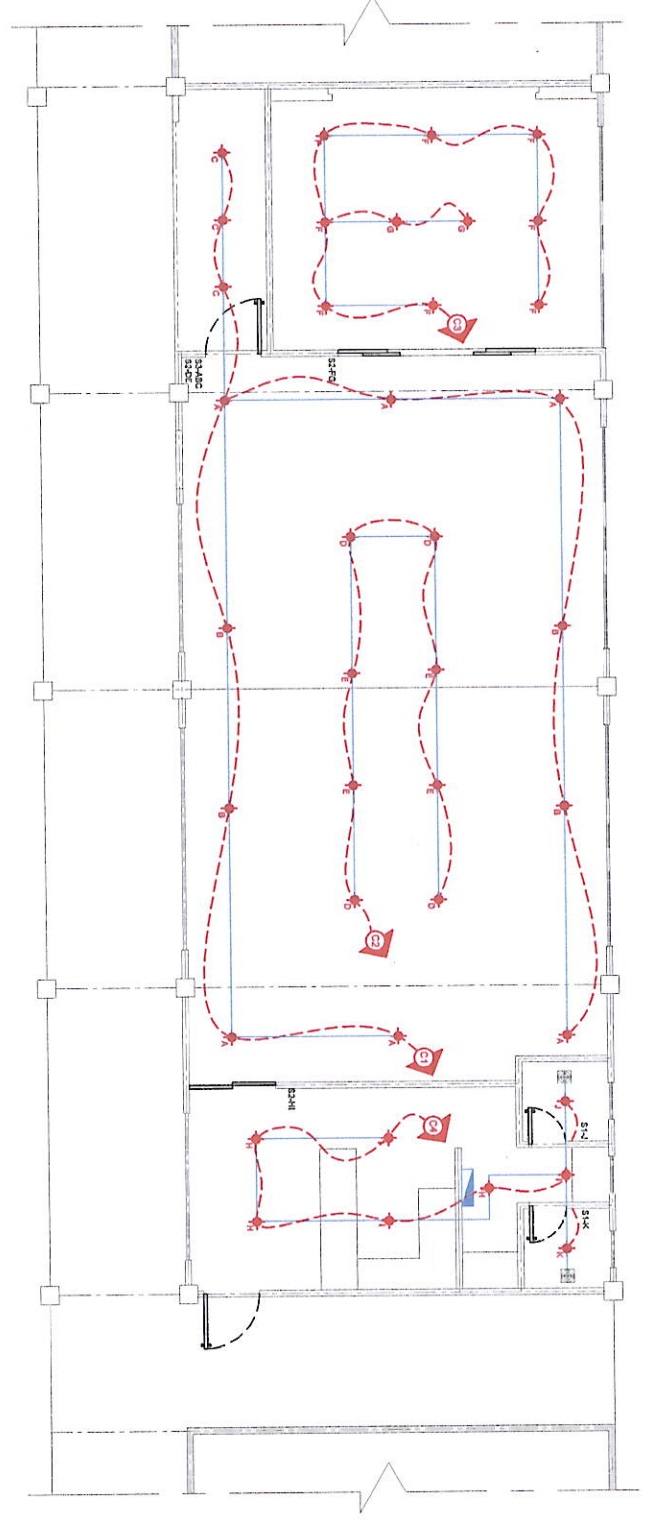

**5 LIGHTING LAYOUT PLAN**  
SCALE 1:120 METERS

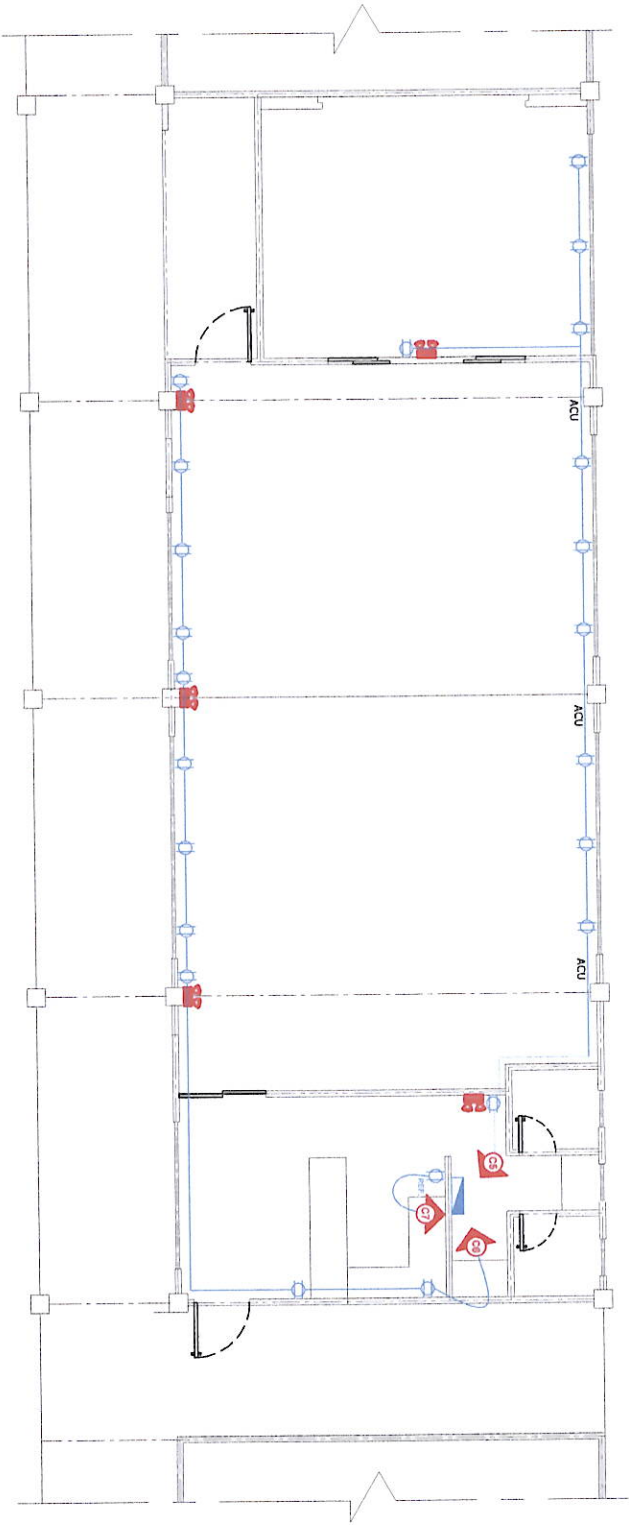

**6 POWER LAYOUT PLAN**  
SCALE 1:120 METERS

<p>Republic of the Philippines CARLOS HILADO MEMORIAL STATE UNIVERSITY Negros Occidental</p>		<p>PROJECT TITLE: <b>REPAIR AND ENHANCEMENT OF FACULTY ROOM AT CHMSU-BINALABAGAN CAMPUS</b></p>		<p>ENDORSED BY:  EXECUTIVE DIRECTOR, BINALABAGAN</p>		<p>PREPARED BY:  MA. LECHE M. VILATURA DIARTSMAN, P.M.U. - BINALABAGAN CAMPUS</p>		<p>CHECKED BY:  AP. ARKEL M. SULTAN, UOP PROJECT DEVELOPMENT OFFICER II, P.M.U.</p>		<p>RECOMMENDING APPROVAL:  ENER. JUN J. MARGUET DIRECTOR, PROJECT MANAGEMENT UNIT</p>		<p>APPROVED BY:  NORBERTO P. MANGUABNAN, Ph.D. SUC PRESIDENT III</p>		<p>SHEET NO: <b>E1</b> PAGE NO: <b>1</b></p>	
<p>PROJECT MANAGEMENT UNIT</p>		<p>PROJECT LOCATION: BINALABAGAN CAMPUS</p>		<p>CIVIL ENGINEER, P.M.U. - BINALABAGAN CAMPUS</p>		<p>ENGR. JOHN CARLO T. GANON</p>		<p>ENGR. JHANE O. GIMANEZ</p>		<p>PROJECT DEVELOPMENT OFFICER III, P.M.U.</p>		<p>OIC - VP, PRESIDENT FOR ADMINISTRATION</p>		<p>SUC PRESIDENT III</p>	

**GENERAL NOTES:**

1. ALL SANITARY WORKS INCLUDE HEREIN SHALL BE EXECUTED ACCORDING TO THE PROVISIONS OF THE NATIONAL PLUMBING CODE OF THE PHILIPPINES, THE NATIONAL BUILDING CODE OF THE PHILIPPINES AND ITS IMPLEMENTING RULES AND REGULATIONS.
  2. PROPOSED SANITARY UTILITIES SHALL CONFORM TO THE CRITICAL LOCATION, DEPTH AND INVERT ELEVATION OF EXISTING PIPES.
  3. LOCATION: NO SEPTIC TANK SHALL BE INSTALLED WITHIN OR UNDER ANY STRUCTURE.
  4. TANKS MUST BE BUILT WATER TIGHT OF CONCRETE, PRECAST OR BRICK STONE.
  5. BOTH COMPARTMENTS ARE PROVIDED WITH MANHOLE AND TIGHT COVERS FOR CLEANING AND NECESSARY REPAIR.
  6. ALL FIXTURES SHALL BE TESTED, UNLESS OTHERWISE NOTED.
  7. COORDINATE THE DRAWING WITH OTHER RELATED DRAWINGS AND SPECIFICATION.
- THE ARCHITECT/AND OR ENGINEER SHALL BE NOTIFIED IMMEDIATELY OF ANY DISCREPANCY FOUND THEREIN, IMMEDIATELY OF ANY DISCREPANCY FOUND THEREIN, HIS/HER DECISION SHALL BE FINAL.

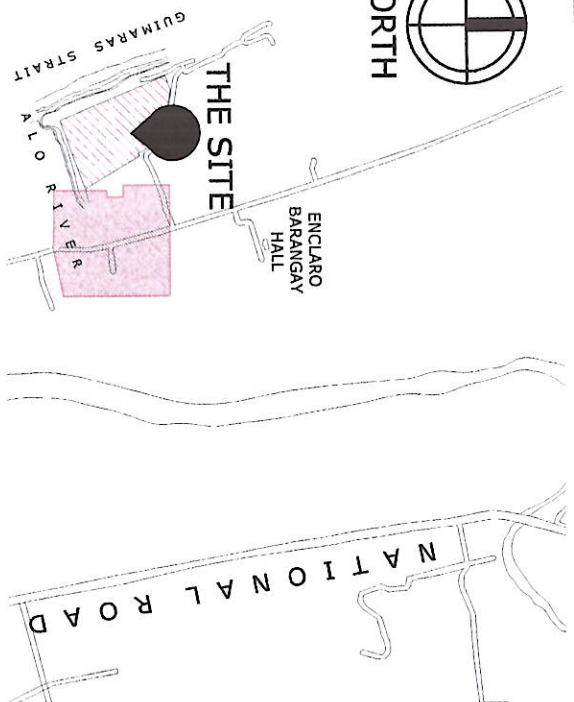
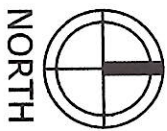

SP	SANITARY PIPE
—	WATER PIPE LINE
—	WATER SOURCE LINE
—	WATER METER
WC	WATER CLOSET
KS	KITCHEN SINK
FD	FLOOR DRAIN
Ø	DIAMETER
FAU.	FAUCET
CO	CLEAN-OUT
VTR	VENT THRU ROOF
GT	GREASE TRAP

**1 GENERAL NOTES**  
SCALE: NOT TO SCALE

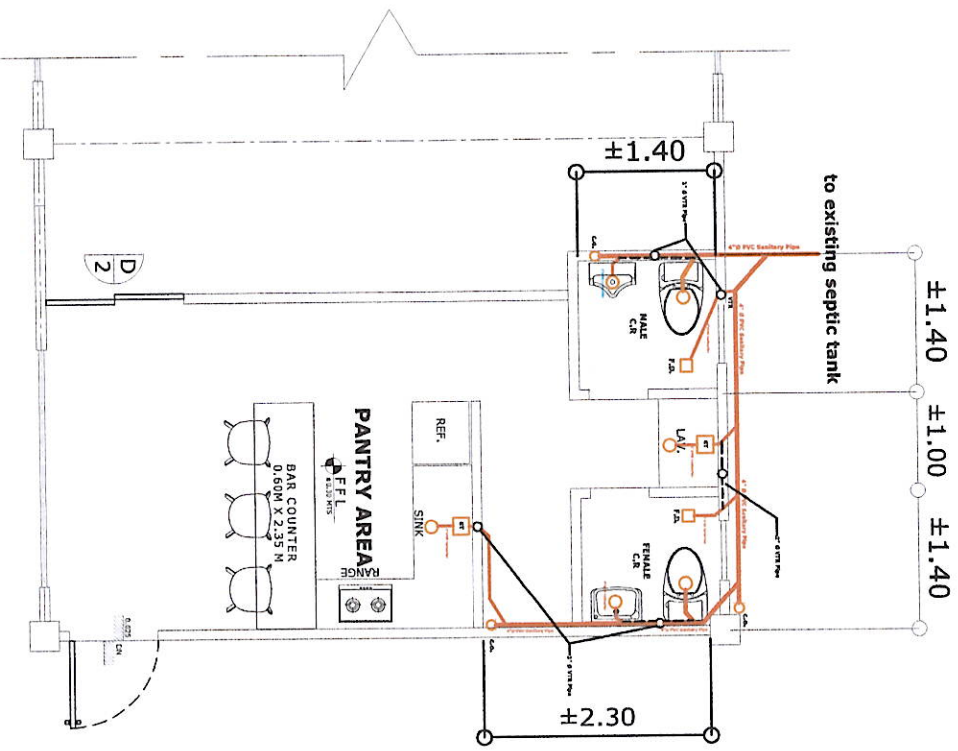

**2 VICINITY PLAN**  
SCALE: NOT TO SCALE

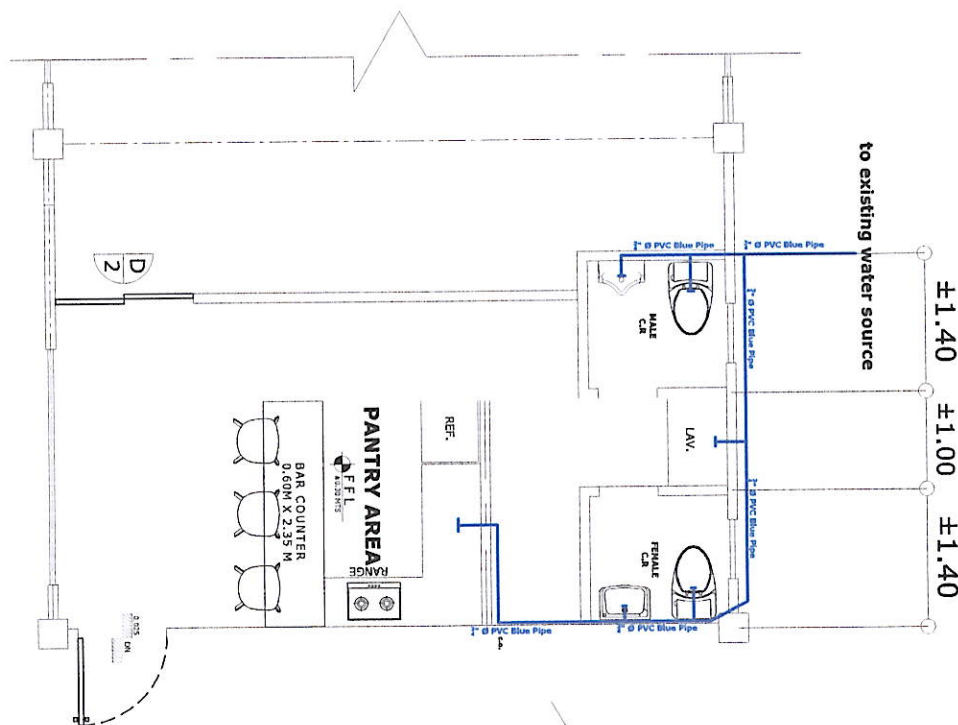

**3 LEGEND**  
SCALE: NOT TO SCALE

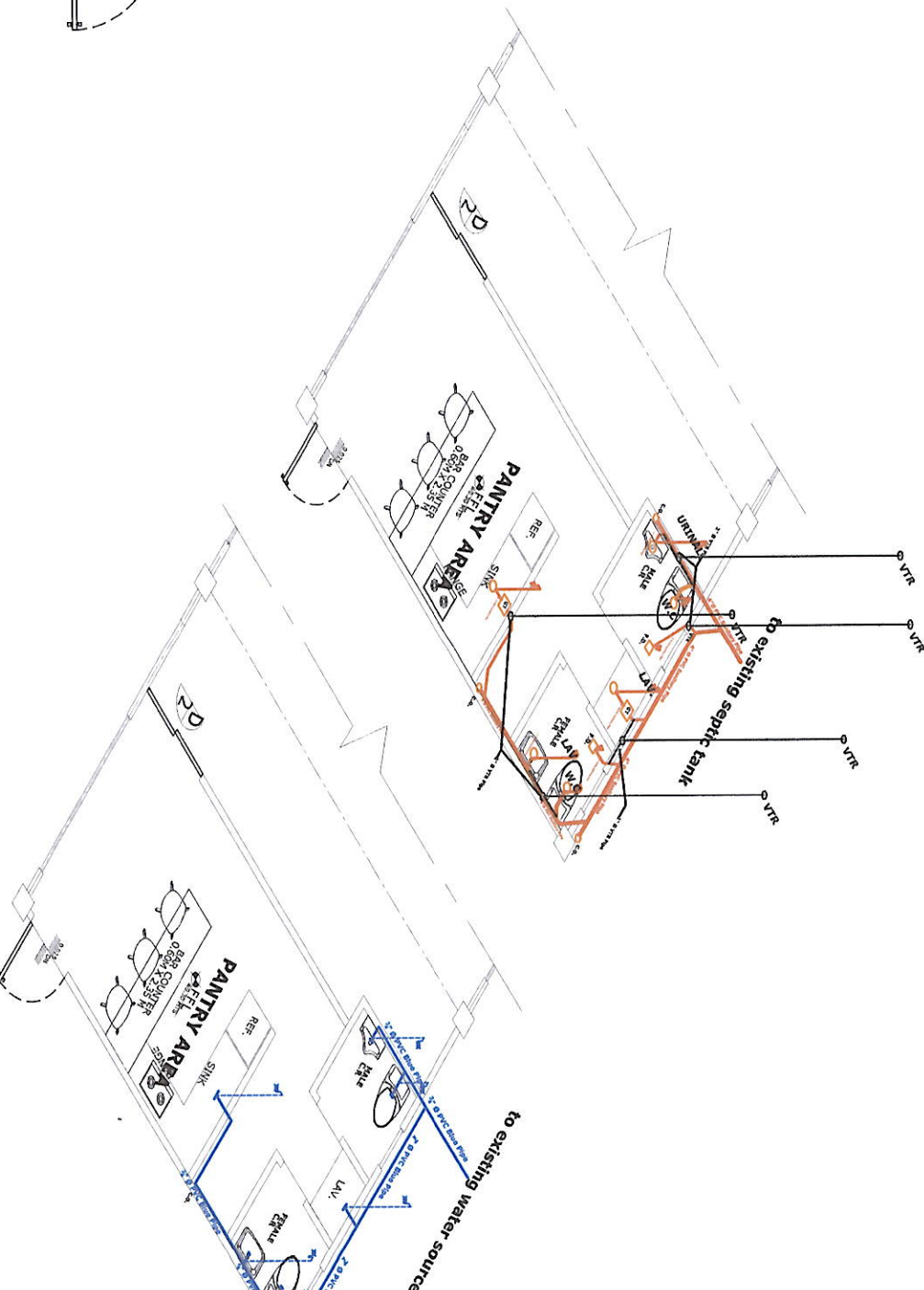

**4 SANITARY LINE LAYOUT PLAN**  
SCALE: 1:75 METERS

**5 WATER LINE LAYOUT PLAN**  
SCALE: 1:75 METERS

**6 PLUMBING ISOMETRIC LAYOUT PLAN**  
SCALE: 1:75 METERS

<p>Republic of the Philippines CARLOS HILADO MEMORIAL STATE UNIVERSITY Negros Occidental</p>	PROJECT TITLE:	ENDORSED BY:	PREPARED BY:	CHECKED BY:	RECOMMENDING APPROVAL:	APPROVED BY:	SHEET NO.:	PAGE NO.:
	REPAIR AND ENHANCEMENT OF FACULTY ROOM AT CHMSU-BINALBAGAN CAMPUS	JOVELLE B. VARGARA, EDD. EXECUTIVE DIRECTOR, BINALBAGAN	MA. LEONILA M. VILLATURBA DRAFTSMAN, PMLU - BINALBAGAN CAMPUS ENGR. JOHN CARLO F. GANON CIVIL ENGINEER, PMLU - BINALBAGAN CAMPUS	APRIL M. MADRIGAL, LDP PROJECT DEVELOPMENT OFFICER III, PMU ENGR. DESIRE D. CHAVEZ PROJECT DEVELOPMENT OFFICER III, PMU	ENGR. JUN-JUN J. MARGARIT	JAY B. ESTRELLAS, EDD. OIC - VICE RESIDENT FOR ADMINISTRATION	NORBERTO P. MANGULABANAN, PH.D. SUC. PRESIDENT III	P 1
PROJECT LOCATION: BINALBAGAN CAMPUS								